



www.ecivalve.it

Technical Valve Catalogue

Production of the
Best Quality
Range of Valves





BRONZE VALVES



BRASS VALVES



CAST-IRON VALVES

General Index

| | |
|---|-----------|
| General Index | 3 |
| Bronze Valves | 5 |
| BR 118 | 6 |
| BR 120 | 7 |
| BR 140 | 8 |
| BR 220 | 9 |
| BR 325 | 10 |
| BR 432 | 11 |
| BR 516 | 12 |
| BR 520 | 13 |
| BR 525 | 14 |
| BR 582 | 15 |
| BR 825 | 16 |
| Valve Instalation Tips | 17 |
| Brass Valves | 20 |
| BS 135 | 21 |
| BS 202 | 22 |
| BS 302 | 23 |
| BS 501 | 24 |
| BS 502 | 25 |
| BS 910 | 26 |
| Cast-Iron Valves | 28 |
| G 101 | 29 |
| G 103 | 30 |
| G 201 | 31 |
| G 203 | 32 |
| G 301 | 33 |
| G 303 | 34 |
| G 311 | 35 |
| G 401 | 36 |
| G 403 | 37 |
| G 501 | 38 |
| G 503 | 39 |
| G 505 | 40 |
| G 507 | 41 |
| G 511 | 42 |
| G 801 | 43 |
| Pressure Independent Control Valves (PICV) | 45 |
| BS 925 (PICV) | 46 |
| Valve Accessories | 53 |
| V1100/V1200 | 54 |
| Certifications | 55 |
| Notes | 56 |



European Casting Industry ECI is dedicated to manufacturing the best quality of wide range valves. Our goal is to provide first class quality and standards to our clients. ECI valves have a wide range of use in the heating, ventilating, and air-conditioning systems, while also being applicable in the oil and gas fields. Each of our products has been systematically tested and monitored to ensure that the standards of quality are being met.

ECI produces the same valves with different standards, this allow better distribution of valves to more areas around the world, particularly in the Middle East, Europe and North America.

Bronze Valves

| | |
|--------|----|
| BR 118 | 6 |
| BR 120 | 7 |
| BR 140 | 8 |
| BR 220 | 9 |
| BR 325 | 10 |
| BR 432 | 11 |
| BR 516 | 12 |
| BR 520 | 13 |
| BR 525 | 14 |
| BR 582 | 15 |
| BR 825 | 16 |

BR 118

BRONZE BALL VALVE

WORKING PRESSURE PN 25

FULL BORE

TAPER PIPE THREADED TO ISO 7

DESIGN STANDARD GB/T8464



www.ecivalve.it

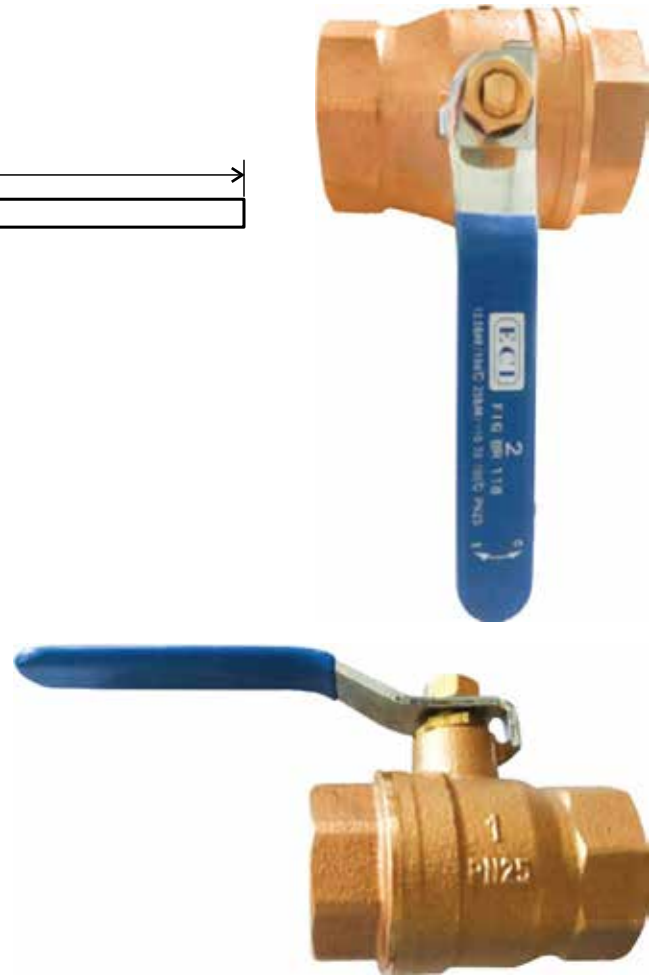
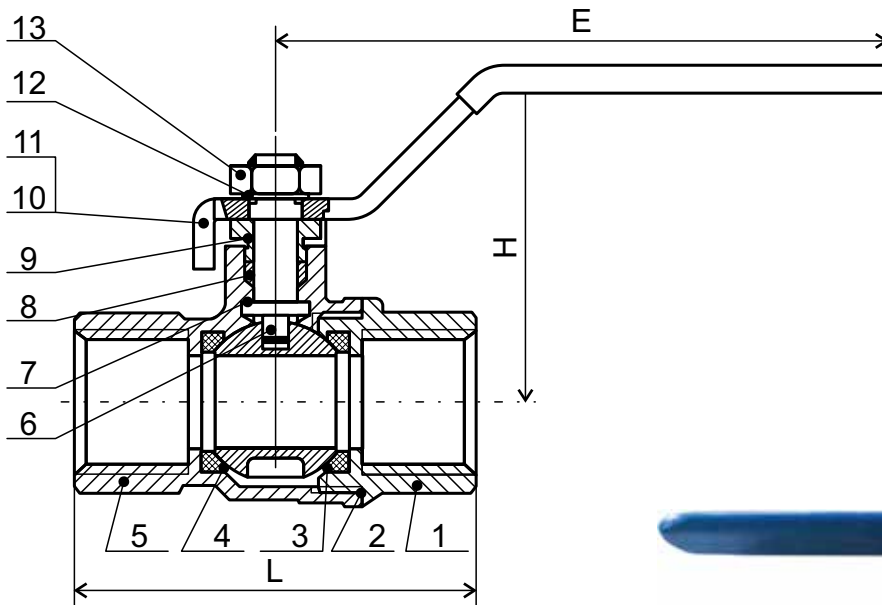

Specifications:

- WORKING PRESSURE: PN 25
- WORKING TEMPERATURE: $T \leq 170^{\circ}\text{C}$
- PORT SIZE:
 $\frac{1}{2}''$ UP TO $2''$
 FULL PORT
- TESTING PRESSURE: 100 PSI AIR FOR SHELL & SEAT
- TAPER PIPE THREADED TO NPT AND ISO 7-1 (EX. BS-21)
- SUITABLE MEDIA: WATER, OIL, AIR, & STEAM

Dimensions (mm)

| DN | SIZE INCH | L | H | E | Weight(KGS) |
|----|------------------|-----|----|-----|-------------|
| 15 | $\frac{1}{2}''$ | 53 | 44 | 95 | 0.228 |
| 20 | $\frac{3}{4}''$ | 61 | 51 | 110 | 0.366 |
| 25 | $1''$ | 71 | 55 | 110 | 0.539 |
| 32 | $1\frac{1}{4}''$ | 85 | 65 | 140 | 0.838 |
| 40 | $1\frac{1}{2}''$ | 92 | 70 | 140 | 1.133 |
| 50 | $2''$ | 114 | 83 | 160 | 1.880 |

Materials

| No. | DESCRIPTION | BRONZE |
|-----|---------------|--------------------------|
| 1 | Seat retainer | Bronze CC491K |
| 2 | Packing | P.T.F.E |
| 3 | Seat | P.T.F.E |
| 4 | Ball | Brass CW617N |
| 5 | Body | Bronze CC491K |
| 6 | Stem | DZR Brass CW602N |
| 7 | Stem | P.T.F.E |
| 8 | Packing | P.T.F.E |
| 9 | Gland Nut | Brass CW617N |
| 10 | Lever | Mild Steel Chrome Plated |
| 11 | Lever | PVC |
| 12 | Washer | Stainless Steel |
| 13 | Nut | Stainless Steel |



All data, descriptions and pictures contained in this leaflet may be subject to change without prior notice.

European Casting Industry Srl | Via Lazzaretto, 11 | 20124 Milan MI, Italia | P.Iva: 03228761205 | www.ecivalve.it | info@ecivalve.it

BR 120

BRONZE BALL VALVE

600 PSI / 41.4 BAR WOG

150 PSI / 10.3 BAR WSP

½"~1" FULL PORT

1¼"~4" CONVENTIONAL PORT

Conforms to MSS SP-110

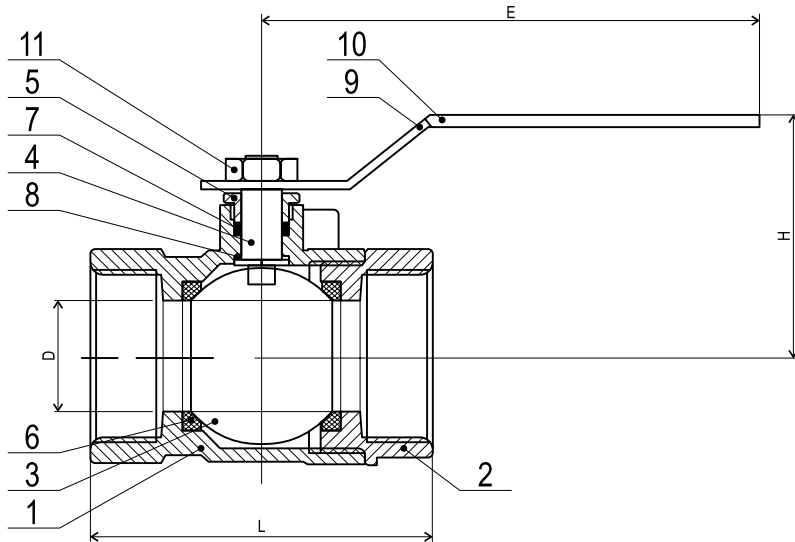

Specifications:

- WORKING PRESSURE:
600 PSI / 41.4 BAR WOG
150 PSI / 10.3 BAR WSP
- WORKING TEMPERATURE: $T \leq 140^{\circ}\text{C}$
- PORT SIZE:
½"~1" FULL PORT
1¼"~4" RED PORT (CONVENTIONAL)
- TESTING PRESSURE: 100 PSI AIR FOR SHELL & SEAT
- TAPER PIPE THREADED TO NPT AND ISO 7-1 (ex. BS-21)
- SUITABLE MEDIA: WATER, OIL, AIR & STEAM

Dimensions (mm)

| DN | SIZE INCH | L | H | E | Weight(KGS) |
|----|-----------|-----|-----|-----|-------------|
| 15 | ½" | 61 | 48 | 102 | 0,399 |
| 20 | ¾" | 74 | 56 | 122 | 0,581 |
| 25 | 1" | 86 | 65 | 122 | 0,889 |
| 32 | 1¼" | 102 | 69 | 122 | 1.406 |
| 40 | 1½" | 109 | 79 | 175 | 2.177 |
| 50 | 2" | 117 | 84 | 175 | 3.039 |
| 65 | 2½" | 150 | 91 | 175 | 3.856 |
| 80 | 3" | 180 | 114 | 201 | 6.713 |

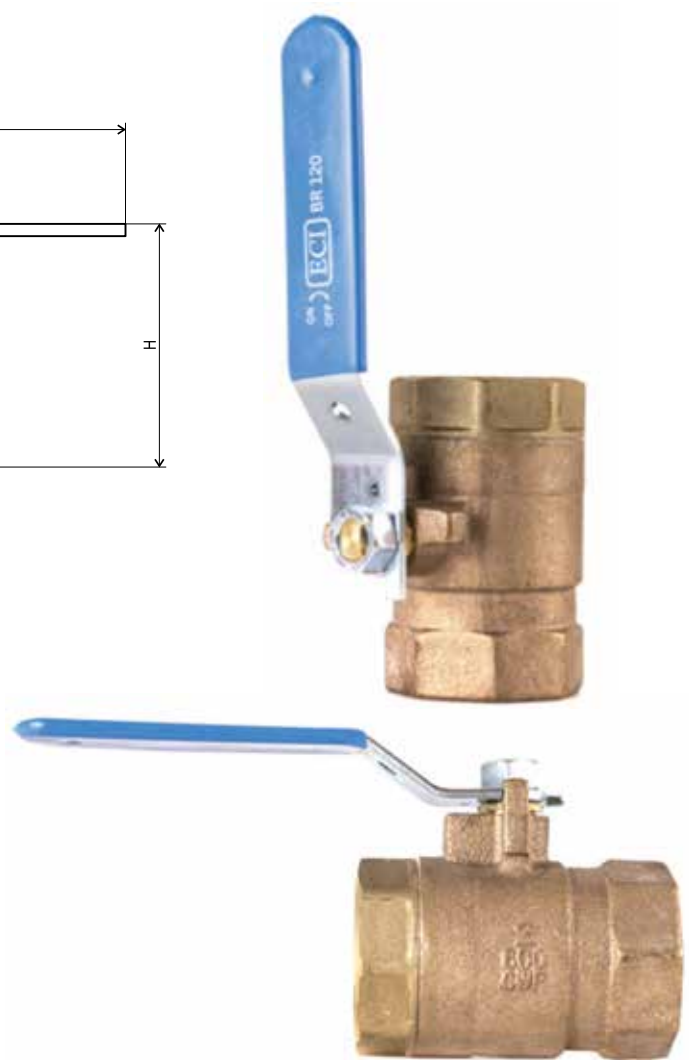

Materials

| No. | DESCRIPTION | BRONZE | LEAD FREE |
|-----|---------------|-----------------------------------|---------------------|
| 1 | Body | ASTM B584 C84400 | ASTM C89844 |
| 2 | Tailpiece | ASTM B584 C84400 | ASTM C89844 |
| 3 | Ball | ASTM B16 C36000 or B124 C37700 | Stainless Steel 316 |
| 4 | Stem | ASTM B16 C36000 | ASTM C46400 |
| 5 | Packing Nut | ASTM B16 C36000 | ASTM B16 C36000 |
| 6 | Ball Seat | 15% Glass RPTFE | TEFLON PTFE |
| 7 | Packing | TEFLON PTFE | TEFLON PTFE |
| 8 | Thrust Washer | TEFLON PTFE | TEFLON PTFE |
| 9 | Handle | Steel-Zn.P. | Steel-Zn.P. |
| 10 | Handle Sleeve | Vinyl | Vinyl |
| 11 | Handle Nut | Steel-Zn.P. | Steel-Zn.P. |

BR 140

BRONZE BALL VALVE

WORKING PRESSURE 600PSI/41 BAR CWP

STAINLESS STEEL 316 BALL

CONFORMS TO MSS SP110

www.ecivalve.it

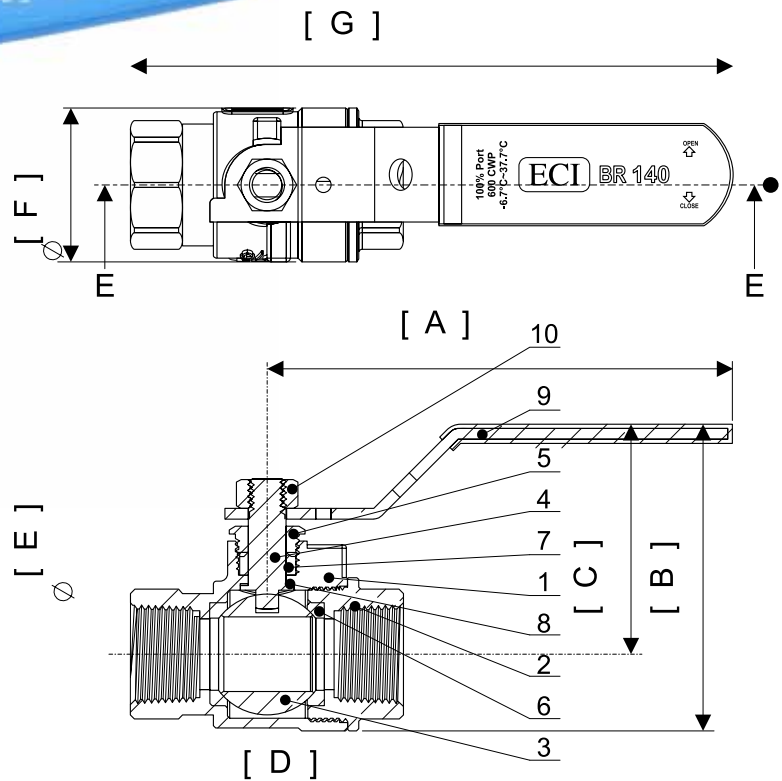
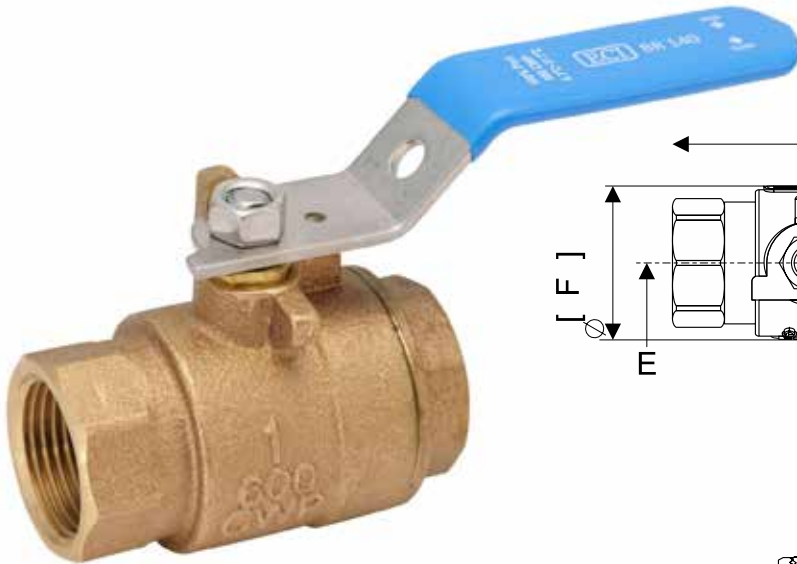

Materials

| No. | DESCRIPTION | MATERIAL |
|-----|---------------|----------------------------------|
| 1 | Body | Bronze C84400 |
| 2 | Tailpiece | Bronze C84400 |
| 3 | Ball | Stainless Steel 316 |
| 4 | Stem | Stainless Steel 316 |
| 5 | Packing nut | Brass |
| 6 | Ball seat | PTFE |
| 7 | Packing gland | PTFE |
| 8 | Thrust washer | PTFE |
| 9 | Handle | Stainless Steel 304 + Vinyl Grip |
| 10 | Nut | Stainless Steel 304 |

Specifications

- WORKING PRESSURE: 41 BAR UP TO 37°C 7 BAR AT 140°C
- MAX WORKING TEMPERATURE: ≤ 140°C
- PORT SIZE: 1/2" UP TO 2" FULL PORT
- TAPER PIPE THREADED TO BSPT (ISO 7) OR NPT
- SUITABLE MEDIUM: WATER, SEA WATER, OIL, AIR AND STEAM

Dimension table BR140 (mm)

| DN | A | B | C | D | E | F | G | WEIGHT (KG) |
|----|-------|--------|------|-------|------|------|--------|-------------|
| 15 | 100.6 | 66.85 | 50.5 | 61.8 | 12.7 | 32.7 | 130.45 | 0.30 |
| 20 | 121 | 82 | 61.5 | 71 | 19.1 | 41 | 156.6 | 0.51 |
| 25 | 121 | 90.5 | 65.7 | 83.4 | 25 | 50 | 162.7 | 0.79 |
| 32 | 141 | 99.21 | 70.1 | 93.6 | 32 | 58.5 | 188 | 1.02 |
| 40 | 177.4 | 120.95 | 86.7 | 103.6 | 38 | 67.4 | 229.35 | 1.56 |
| 50 | 177.4 | 138.5 | 94.5 | 116.5 | 50 | 88 | 235.7 | 2.60 |



All data, descriptions and pictures contained in this leaflet may be subject to change without prior notice.

European Casting Industry Srl | Via Lazzaretto, 11 | 20124 Milan MI, Italia | P.Iva: 03228761205 | www.ecivalve.it | info@ecivalve.it

BR 220

BRONZE STRAINER

PN 20 "Y" TYPE



www.ecivalve.it

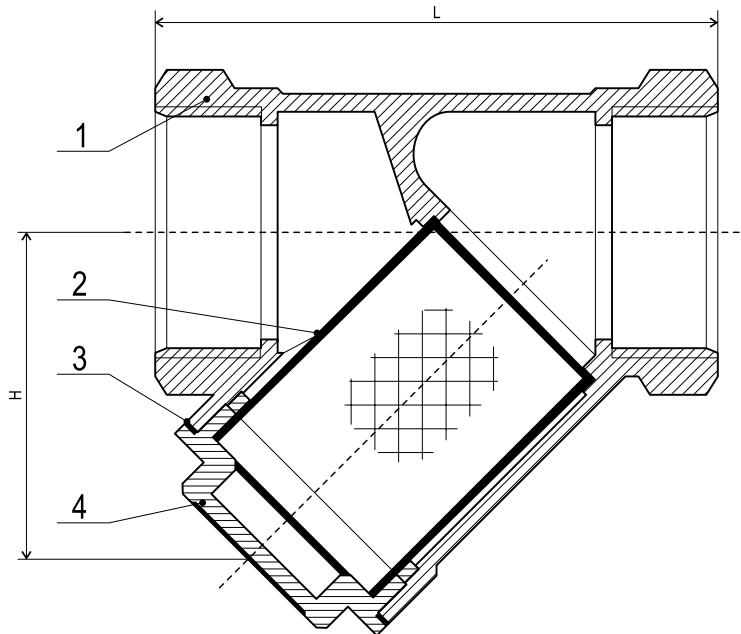

Specifications:

- PRESSURE RATING: PN20
- SUITABLE MEDIA: WATER, OIL, AIR & GAS
- WORKING TEMPERATURE: $T \leq 170^{\circ}\text{C}$
- TAPER PIPE THREAD TO NPT AND ISO 7-1 (EX. BS-21)

Dimensions (mm)

| DN | SIZE INCH | L | H | Weight(KGS) |
|----|-----------|-----|----|-------------|
| 15 | ½" | 58 | 33 | 0.185 |
| 20 | ¾" | 70 | 41 | 0.298 |
| 25 | 1" | 88 | 49 | 0.426 |
| 32 | 1¼" | 96 | 56 | 0.720 |
| 40 | 1½" | 107 | 62 | 0.980 |
| 50 | 2" | 126 | 80 | 1.500 |

Materials

| No. | DESCRIPTION | BRONZE |
|-----|-------------|--------------------------|
| 1 | Body | Bronze CC491K |
| 2 | Screen | Stainless Steel Type 304 |
| 3 | Gasket | P.T.F.E |
| 4 | Cap | Bronze CC491K |



All data, descriptions and pictures contained in this leaflet may be subject to change without prior notice.

European Casting Industry Srl | Via Lazzaretto, 11 | 20124 Milan MI, Italia | P.Iva: 03228761205 | www.ecivalve.it | info@ecivalve.it

BR 325

BRONZE CHECK VALVE

PN 25 SWING TYPE

Conforms to MSS SP-80

www.ecivalve.it

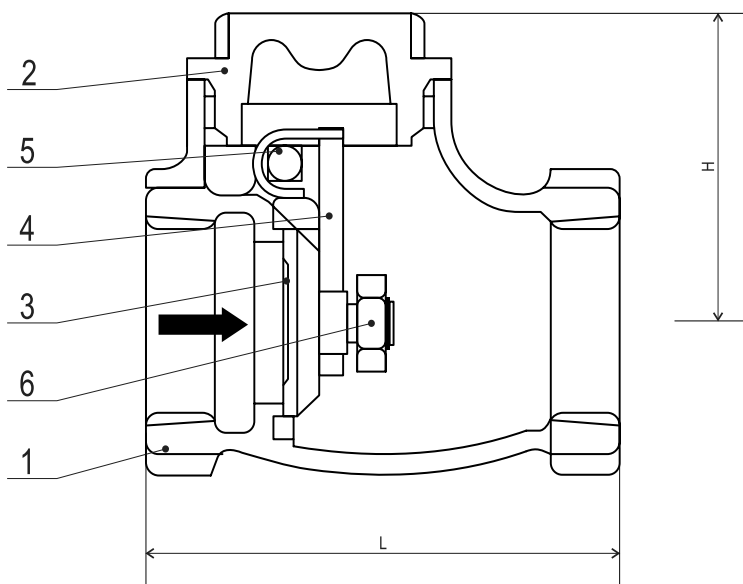

Specifications:

- PRESSURE RATING: PN25
- SUITABLE MEDIA: WATER, OIL, AIR & STEAM
- WORKING TEMPERATURE: $T \leq 170^{\circ}\text{C}$
- TAPER PIPE THREAD TO NPT AND ISO 7-1 (EX. BS-21)

Dimensions (mm)

| DN | SIZE INCH | L | H | Weight(KGS) |
|----|-----------|-----|----|-------------|
| 10 | 3/8" | 48 | 33 | 0.301 |
| 15 | 1/2" | 58 | 38 | 0.332 |
| 20 | 3/4" | 66 | 42 | 0.440 |
| 25 | 1" | 80 | 49 | 0.687 |
| 32 | 1 1/4" | 89 | 56 | 1.010 |
| 40 | 1 1/2" | 95 | 65 | 1.423 |
| 50 | 2" | 108 | 76 | 2.390 |

Materials

| No. | DESCRIPTION | MATERIAL |
|-----|-------------|-----------------------------|
| 1 | Body | Bronze CC491K |
| 2 | Cap | Bronze CC491K |
| 3 | Disc | Bronze CC491K (1.1/4" - 2") |
| 3 | Disc | Brass CW617N (3/8" - 1") |
| 4 | Hinge | Bronze CC491K |
| 5 | Hinge Pin | Stainless Steel |
| 6 | Hinge Nut | Brass CW617N |



All data, descriptions and pictures contained in this leaflet may be subject to change without prior notice.

European Casting Industry Srl | Via Lazzaretto, 11 | 20124 Milan MI, Italia | P.Iva: 03228761205 | www.ecivalve.it | info@ecivalve.it

BR 432

BRONZE GLOBE VALVE

PN 32

Rising stem

Conforms to BS 5154/MSS SP-80



www.ecivalve.it

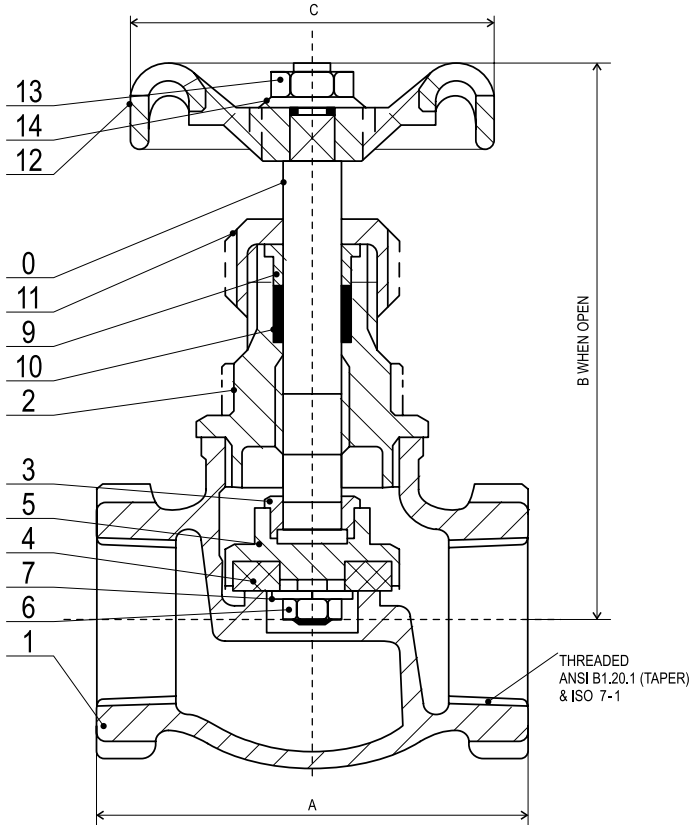

Specifications:

- PRESSURE RATING: PN32
- SUITABLE MEDIA: WATER, OIL, AIR & STEAM
- WORKING TEMPERATURE: $T \leq 180^{\circ}\text{C}$
- TAPER PIPE THREAD TO NPT AND ISO 7-1 (EX. BS-21)

Dimensions (mm)

| DN | SIZE INCH | A | B | C | Weight(KGS) |
|----|-----------|-----|-----|-----|-------------|
| 15 | ½" | 62 | 101 | 52 | 0.540 |
| 20 | ¾" | 74 | 115 | 52 | 0.650 |
| 25 | 1" | 90 | 125 | 70 | 0.810 |
| 32 | 1¼" | 100 | 150 | 70 | 1.550 |
| 40 | 1½" | 115 | 159 | 92 | 2.010 |
| 50 | 2" | 136 | 191 | 103 | 3.080 |

Materials

| No. | DESCRIPTION | MATERIAL |
|-----|----------------|---------------|
| 1 | Body | Bronze CC491K |
| 2 | Bonnet | Bronze CC491K |
| 3 | Disc Stem Ring | Brass CW602N |
| 4 | Disc | P.T.F.E |
| 5 | Disc Holder | Bronze CC491K |
| 6 | Disc Nut | Brass CW602N |
| 7 | Washer | Brass CW602N |
| 8 | Stem | Brass CW602N |
| 9 | Gland | Brass CW614N |
| 10 | Packing | Asbestos Free |
| 11 | Packing Nut | Brass CW614N |
| 12 | Handwheel | Aluminum |
| 13 | Handwheel Nut | Brass CW614N |
| 14 | I.D Plate | Aluminum |



All data, descriptions and pictures contained in this leaflet may be subject to change without prior notice.

European Casting Industry Srl | Via Lazzaretto, 11 | 20124 Milan MI, Italia | P.Iva: 03228761205 | www.ecivalve.it | info@ecivalve.it

BR 516

BRONZE GATE VALVE

PN16

Non-Rising stem

Conforms to PED 97/23/CE & it is CE marking-free as per art. 3 par.3

www.ecivalve.it

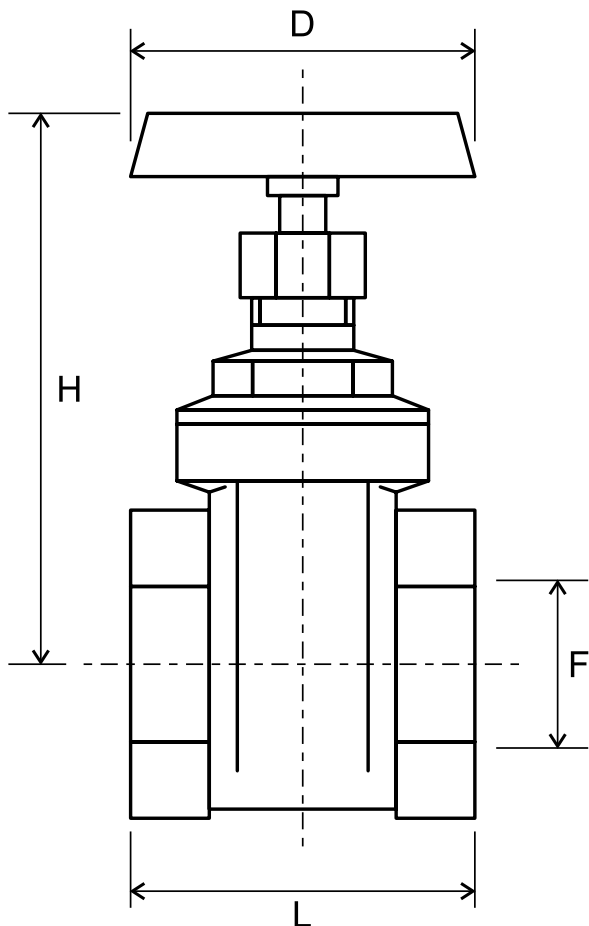

Specifications:

- PRESSURE RATING: PN16
- SUITABLE MEDIA: WATER, OIL & AIR
- WORKING TEMPERATURE: $T \leq 80^{\circ}\text{C}$
- TAPER PIPE THREAD TO NPT AND ISO 228/1

Dimensions (mm)

| DN | SIZE INCH | F | L | H | D | Weight(KGS) |
|----|-----------|----|----|-----|----|-------------|
| 15 | ½" | 15 | 38 | 68 | 45 | 0.195 |
| 20 | ¾" | 19 | 45 | 78 | 50 | 0.280 |
| 25 | 1" | 24 | 48 | 92 | 55 | 0.380 |
| 32 | 1¼" | 32 | 51 | 108 | 60 | 0.600 |
| 40 | 1½" | 37 | 58 | 125 | 70 | 0.830 |
| 50 | 2" | 47 | 62 | 145 | 80 | 1.210 |

Materials

| DESCRIPTION | MATERIAL |
|---------------|-----------------------------------|
| Body | Bronze SN 5 UNI-EN1982 DIN50930/6 |
| Bonnet | Brass CW 617 N-UNI-EN12165 |
| Stem | Brass CW 614 N-UNI-EN12164 |
| Packing | EPDM90 DUTRAL |
| Wedge | Brass DELTA CS UNI-EN1982 CB 7535 |
| Handwheel | Steel with blue plastic coating |
| Handwheel Nut | Steel Zinc plated |



All data, descriptions and pictures contained in this leaflet may be subject to change without prior notice.

European Casting Industry Srl | Via Lazzaretto, 11 | 20124 Milan MI, Italia | P.Iva: 03228761205 | www.ecivalve.it | info@ecivalve.it

BR 520

BRONZE GATE VALVE

PN 20
Non-Rising stem
Conforms to BS 5154



www.ecivalve.it

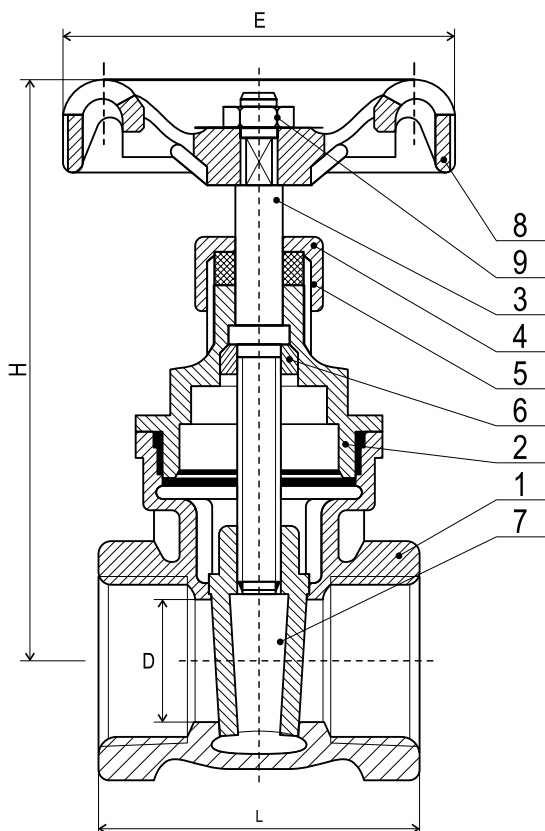

Specifications:

- PRESSURE RATING: PN20
- SUITABLE MEDIA: WATER, OIL, AIR & STEAM
- WORKING TEMPERATURE: $T \leq 170^{\circ}\text{C}$
- TAPER PIPE THREAD TO NPT AND ISO 7-1 (EX. BS-21)

Dimensions (mm)

| DN | SIZE INCH | F | L | H | D | Weight(KGS) |
|----|-----------|------|----|-----|----|-------------|
| 15 | ½" | 12.7 | 50 | 74 | 52 | 0.268 |
| 20 | ¾" | 19.1 | 54 | 85 | 52 | 0.395 |
| 25 | 1" | 25.4 | 62 | 106 | 70 | 0.585 |
| 32 | 1¼" | 31.8 | 70 | 113 | 70 | 0.857 |
| 40 | 1½" | 38.2 | 77 | 132 | 92 | 1.265 |
| 50 | 2" | 50.9 | 87 | 155 | 92 | 1.900 |

Materials

| No. | DESCRIPTION | MATERIAL |
|-----|---------------|------------------|
| 1 | Body | Bronze CC491K |
| 2 | Bonnet | Bronze CC491K |
| 3 | Stem | DZR Brass CW602N |
| 4 | Packing Nut | Brass CW617N |
| 5 | Packing | P.T.F.E |
| 6 | Stem Bush | DZR Brass CW602N |
| 7 | Disc | Bronze CC491K |
| 8 | Handwheel | Aluminum |
| 9 | Handwheel Nut | Brass CW614N |



All data, descriptions and pictures contained in this leaflet may be subject to change without prior notice.

European Casting Industry Srl | Via Lazzaretto, 11 | 20124 Milan MI, Italia | P.Iva: 03228761205 | www.ecivalve.it | info@ecivalve.it

BR 525

BRONZE GATE VALVE

PN 25

Non-Rising stem

Conforms to BS 5154/MSS SP-80



www.ecivalve.it

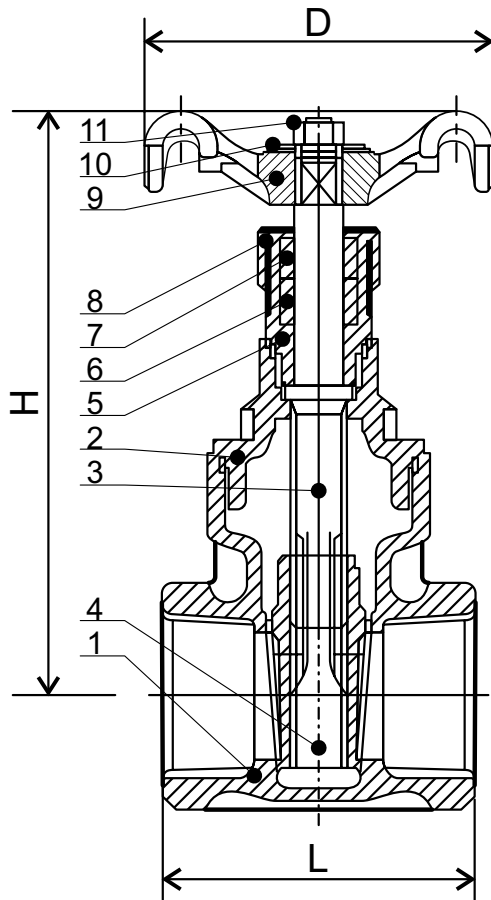

Specifications:

- PRESSURE RATING: PN25
- SUITABLE MEDIA: WATER, OIL, AIR & STEAM
- WORKING TEMPERATURE: $T \leq 170^{\circ}\text{C}$
- TAPER THREAD TO NPT AND ISO 7-1 (EX. BS-21)

Dimensions (mm)

| DN | SIZE INCH | L | H | D | Weight(KGS) |
|----|-----------|----|-----|-----|-------------|
| 8 | ¼" | 46 | 75 | 45 | 0.284 |
| 10 | ⅜" | 46 | 75 | 45 | 0.268 |
| 15 | ½" | 51 | 82 | 52 | 0.341 |
| 20 | ¾" | 55 | 95 | 65 | 0.582 |
| 25 | 1" | 63 | 118 | 70 | 0.878 |
| 32 | 1¼" | 71 | 144 | 79 | 1.360 |
| 40 | 1½" | 73 | 166 | 92 | 1.750 |
| 50 | 2" | 83 | 190 | 103 | 2.810 |

Materials

| No. | DESCRIPTION | MATERIAL |
|-----|----------------------|------------------|
| 1 | Body | Bronze CC491K |
| 2 | Bonnet | Bronze CC491K |
| 3 | Stem | DZR Brass CW602N |
| 4 | Disc | Bronze CC491K |
| 5 | Stuffing Box | DZR Brass CW602N |
| 6 | Packing Ring | P.T.F.E |
| 7 | Gland | Brass CW614N |
| 8 | Packing Nut | Brass CW614N |
| 9 | Handwheel | Aluminum |
| 10 | Identification Plate | Aluminum |
| 11 | Handwheel Nut | Brass CW614N |



All data, descriptions and pictures contained in this leaflet may be subject to change without prior notice.

European Casting Industry Srl | Via Lazzaretto, 11 | 20124 Milan MI, Italia | P.Iva: 03228761205 | www.ecivalve.it | info@ecivalve.it

BR 582

BRONZE GATE VALVE

PN 32

Rising stem

Conforms to BS 5154/MSS SP-80

www.ecivalve.it

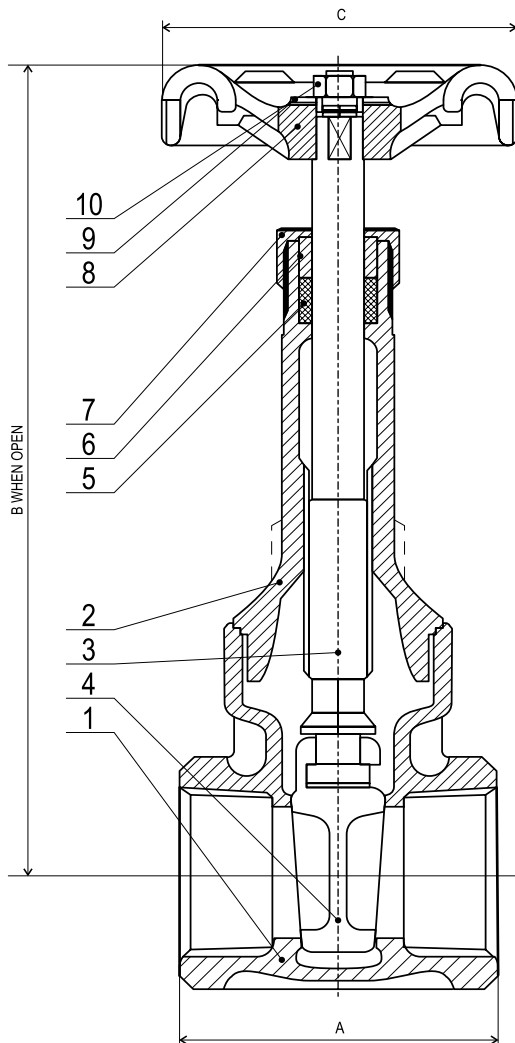

Materials

| No. | DESCRIPTION | MATERIAL |
|-----|---------------|---------------|
| 1 | Body | Bronze CC491K |
| 2 | Bonnet | Bronze CC491K |
| 3 | Stem | Bronze CC491K |
| 4 | Disc | Bronze CC491K |
| 5 | Packing | P.T.F.E |
| 6 | Clamping Ring | Brass CW614N |
| 7 | Packing Nut | Brass CW614N |
| 8 | Handwheel | Aluminum |
| 9 | Id Plate | Aluminum |
| 10 | Handwheel Nut | Brass CW614N |

Dimensions (mm)

| DN | SIZE INCH | A | B | C | Weight(KGS) |
|----|-----------|-----|-----|-----|-------------|
| 8 | ¼" | 46 | 126 | 45 | 0.320 |
| 10 | ⅜" | 46 | 126 | 45 | 0.310 |
| 15 | ½" | 51 | 129 | 52 | 0.400 |
| 20 | ¾" | 55 | 159 | 65 | 0.643 |
| 25 | 1" | 63 | 189 | 70 | 0.998 |
| 32 | 1¼" | 72 | 219 | 78 | 1.519 |
| 40 | 1½" | 73 | 246 | 92 | 2.064 |
| 50 | 2" | 83 | 301 | 92 | 3.191 |
| 65 | 2½" | 108 | 369 | 134 | 5.800 |
| 80 | 3" | 117 | 416 | 134 | 8.520 |

Specifications:

- PRESSURE RATING: PN32
- SUITABLE MEDIA: WATER, OIL, AIR & STEAM
- WORKING TEMPERATURE: T ≤ 170°C
- TAPER PIPE THREAD TO NPT AND ISO 7-1 (EX. BS-21)



All data, descriptions and pictures contained in this leaflet may be subject to change without prior notice.

European Casting Industry Srl | Via Lazzaretto, 11 | 20124 Milan MI, Italia | P.Iva: 03228761205 | www.ecivalve.it | info@ecivalve.it

BR 825

BRONZE FIXED ORIFICE
DOUBLE REGULATING VALVE (DRV)
PN 25
Conforms to BS7350



www.ecivalve.it

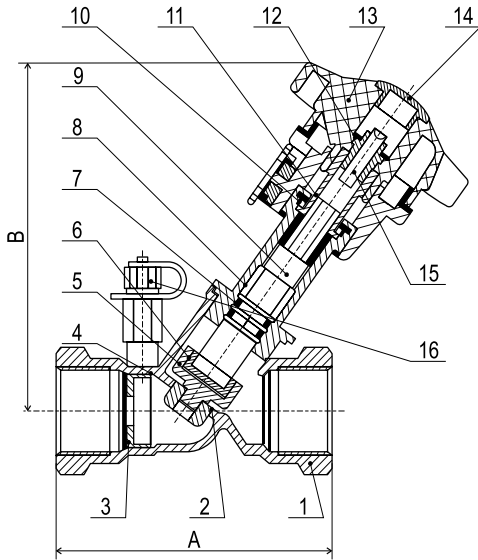

Specifications:

- PRESSURE RATING: PN25
- SUITABLE MEDIUM: WATER
- WORKING TEMPERATURE: $T \leq 120^{\circ}\text{C}$
- TAPER PIPE THREAD TO ISO 7-1 (EX. BS-21)
- Y-PATTERN GLOBE VALVE WITH THROTTLING DISC
- DRV WITH A FIXED ORIFICE DESIGN
- ACCURACY $\pm 5\%$ ON ALL SETTINGS
- DRV ALLOWS VALVE OPENING TO BE SET WITH ALLEN KEY.
- DRV HAS A MICROSET HAND WHEEL
- FOR USE IN HVAC & PLUMBING SYSTEMS
- TO BE USED FOR ISOLATING & TO BE RE-OPENED TO ITS PRE-SET POSITION
- SUPPLIED WITH TWO TEST POINTS
- DESIGN AND MANUFACTURE CONFORM TO BS7350

Dimensions (mm) & Coefficients

| DN | SIZE INCH | A | B | FLOW (KV) | KVS | Weight(KGS) |
|----|-----------|-----|-----|-----------|------|-------------|
| 15 | ½" | 87 | 105 | 1.72 | 2.2 | 0.580 |
| 20 | ¾" | 96 | 106 | 2.97 | 4.6 | 0.650 |
| 25 | 1" | 100 | 127 | 4.75 | 8.5 | 0.890 |
| 32 | 1¼" | 114 | 128 | 10.25 | 16.7 | 1.110 |
| 40 | 1½" | 125 | 143 | 16.83 | 26.1 | 1.460 |
| 50 | 2" | 146 | 144 | 27.26 | 43.2 | 1.980 |

Materials

| No. | DESCRIPTION | MATERIAL | SIZES |
|-----|---------------------|---------------------|--------|
| 1 | Body | Bronze CC491K | All |
| 2 | Disc Face | P.T.F.E | 1"-2" |
| 2 | Disc Face | DZR Brass CW602N | ½"-¾" |
| 3 | Orifice Plate | DZR Brass CW602N | All |
| 4 | Nut | DZR Brass CW602N | All |
| 5 | Disc | DZR Brass CW602N | All |
| 6 | Disc Retaining Ring | DZR Brass CW602N | All |
| 7 | O Ring | N.B.R | All |
| 8 | Bonnet | DZR Brass CW602N | ½"-1¼" |
| 8 | Bonnet | Bronze CC491K | 1½"-2" |
| 9 | Stem | DZR Brass CW602N | All |
| 10 | Retainer Ring | Stainless Steel 304 | All |
| 11 | Sleeve | Brass CW617N | All |
| 12 | Screw | Brass CW614N | All |
| 13 | Handwheel | PA | All |
| 14 | Cap | PA | All |
| 15 | Screw | Stainless Steel 304 | All |
| 16 | Test Points | DZR Brass CW602N | All |



All data, descriptions and pictures contained in this leaflet may be subject to change without prior notice.

European Casting Industry Srl | Via Lazzaretto, 11 | 20124 Milan MI, Italia | P.Iva: 03228761205 | www.ecivalve.it | info@ecivalve.it

Valve Instalation Tips

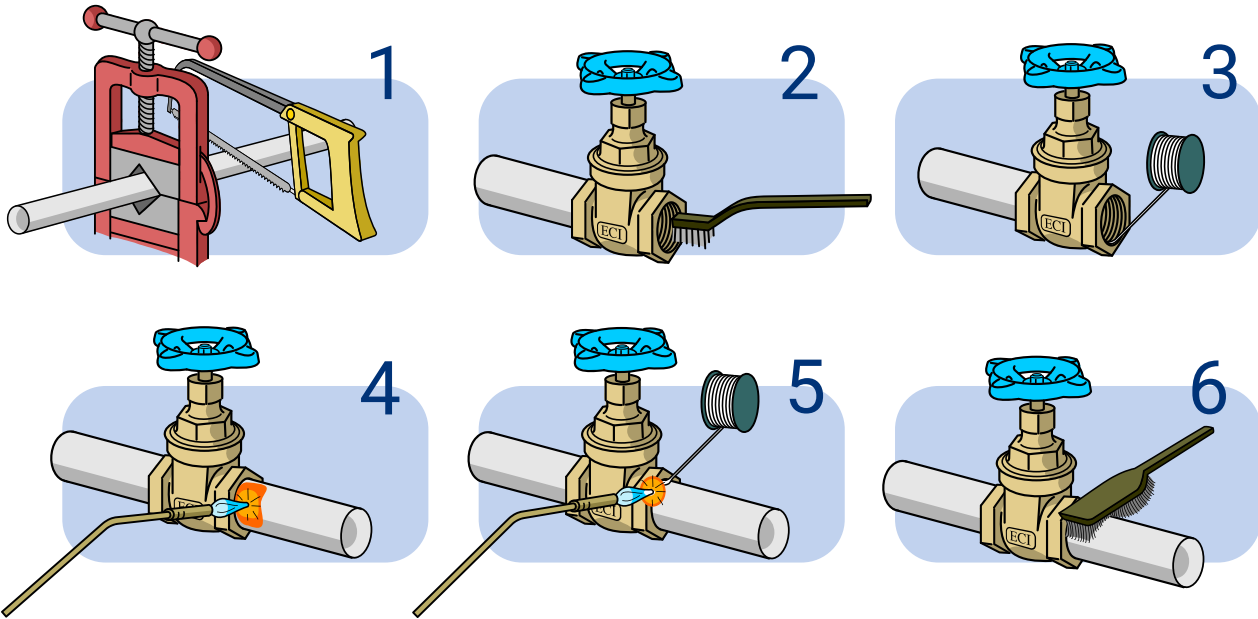

Soldering and Silver Brazing

The most important thing to consider is choosing the correct valve best suited for the application needed. Soldering and silver brazing is the most common method to joining the Bronze valves to tubes or fittings. Poor quality installation can lead to poor and damaged joints. This will lead to leakage and the damaging of the valve.

Perform the following steps to ensure a proper installation:

1 Start by cutting the tube end square, use either a tube cutter or a hack saw. Ream, burr and size the tube according to valve size.

2 Clean both ends of the cut tube, use a sand cloth or steel wire brush or even a nylon abrasive pad. It is important to eliminate all oxides and any soil from the tube ends to ensure a clean flow through the tubes.

3 Apply flux on the outside of the tube ends and the inside of the solder cups. It is best to use a soldering flux that can dissolve and remove any remaining drops of oxide and surface soil from the cleaned surfaces to be joined. It is important that the surface that will be joined to be completely covered in a thin layer of flux.

4 Make sure the valve is fully open. Start by applying heat to the tube ends first. Use the tube then to transfer the heat to the valve ends.

When using the Silver Brazing Method assemble the part to be brazed. Assemble the tube with the valve ends so that they are joined. It should be noted that the assembly should be firmly supported, and that there can be no change in alignment once the brazing operations starts. Apply flame using a torch to the valve ends. Heat uniformly around the end, moving from valve end to the tube end. Perform heating until noise from heating the flux is gone. For valves that are one-inch and larger it is difficult to raise the temperature around the entire joint to the same temperature. It

is recommended to use a double tip torch to allow a uniform temperature around a larger area. A desirable method is using an oxy-acetylene flame. Make sure that the flame is at least 1 inch away from the valve end. Apply heat uniformly on to the valve. Make sure the flame does not remain on any one point. Overheating the valve ends can lead to a damaged valve.

5 For the wire use a ½" solder for a ½" valve, increase wire size as the size of the valve increases. Excess use of solder can go through the tube and clog the sealing area. A constant run of solder or brazing alloy will be present when the joint is filled.

When using the Silver Brazing Method feed the brazing alloy into the joint between the tube and the fitting. Add the brazing only when the metals are heated to brazing temperatures. The flame can be moved away from the valve and tube end when the brazing alloy is applied. Move the flame back and forth as the alloy is inserted into the joint. The brazing alloy will diffuse readily into space between tube outer wall and valve socket. After the joint area is filled a continuous rim of brazing alloy will be visible.

6 Any flux residue or excess solder should be brushed off. A fillet should be visible around the valve end as it cools.

Silver Brazing Tips

Using different types of brazing materials does not affect how strong the brazing joint is. The strength of the joint depends a lot on the procedure. If the brazing alloy is applied correctly on the outside tube and the valve socket, then the joint will hold.

Threading Connection Tips

Any type of dirt, residue, or soil that go into the valve can highly damage parts of the valve and hinder its effectiveness. When using a threaded pipe connection, clean the threaded area to remove any deposits from it. Use air or steam to thoroughly remove any residue. Applying steam or air through the valve is also a good way to remove unwanted residue that can damage the valve.

Before installation, check line of flow through valve so that valve will function properly. Close valve completely before installation. Apply wrench to hex next to pipe and guard against possible distortion. After installation of valve, support line; a sagging pipe line can distort valve and cause failure.

Flanged Connection Tips

There are several steps to follow to make sure that a flanged joint will be properly assembled. First, clean the joint carefully. Then loosely assemble the joint by putting in the bottom two or three bolts. Then carefully insert the gasket into place. The bottom bolts will help locate the gasket and hold it in position. Then insert the rest of the bolts into place and tighten all of the bolts evenly—not in rotation, but by the cross-over method to load the bolts evenly and eliminate concentrated stresses. The bolts should be checked for tightness after an appropriate interval of use and retightened if necessary.



Brass Valves

| | |
|--------|----|
| BS 135 | 21 |
| BS 202 | 22 |
| BS 302 | 23 |
| BS 501 | 24 |
| BS 502 | 25 |
| BS 910 | 26 |

BS 135

BRASS CHROME PLATED BALL VALVE



www.ecivalve.it

ECI EUROPEAN
CASTING
INDUSTRY

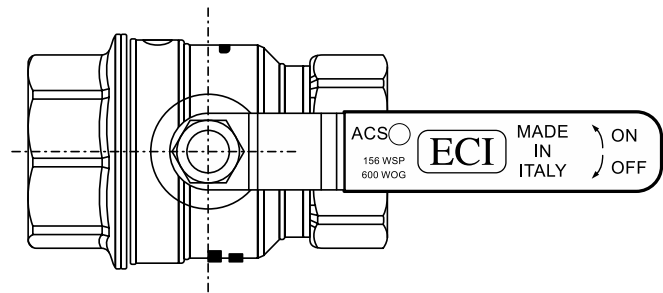
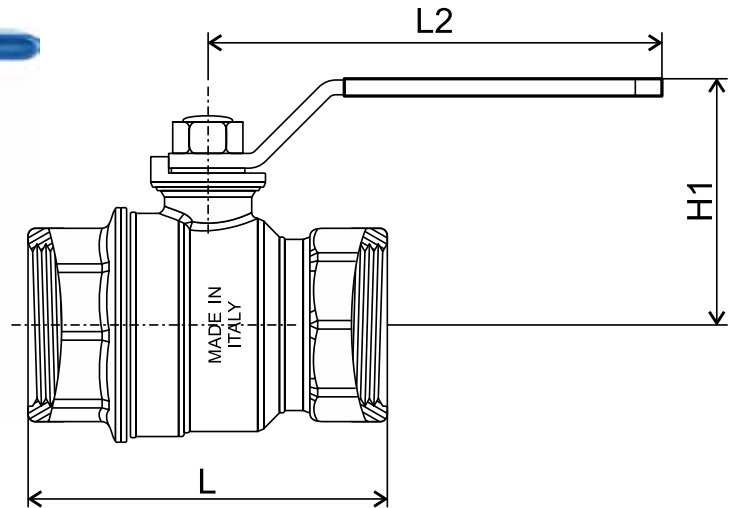

Specifications:

- FULL BORE SIZES 1/2" TO 2"
- STANDARD PASSAGE SIZES 2.1/2" UP TO 4"
- WP: 35 BAR SIZES 1/2" & 3/4" 28 BAR SIZES 1" UP TO 4"
- WORKING TEMPERATURE: T ≤ 140°C
- SUITABLE FOR WATER, GLYCOLATE SOLUTION (GLYCOL 50%)
NON DANGEROUS GAS
- THREADED ACCORDING TO ISO 228/1
- SHELL TEST ACCORDING TO UNI EN 13828

Dimensions (mm)

| DN | SIZE INCH | L | H1 | L2 | Weight(KGS) |
|-----|-----------|-----|-----|-----|-------------|
| 15 | ½" | 53 | 35 | 77 | 0.177 |
| 20 | ¾" | 60 | 47 | 95 | 0.274 |
| 25 | 1" | 74 | 51 | 95 | 0.407 |
| 32 | 1¼" | 84 | 56 | 95 | 0.565 |
| 40 | 1½" | 95 | 69 | 137 | 0.984 |
| 50 | 2" | 109 | 77 | 137 | 1.539 |
| 65 | 2½" | 146 | 102 | 173 | 2.980 |
| 80 | 3" | 160 | 109 | 173 | 4.172 |
| 100 | 4" | 207 | 200 | 187 | 7.004 |

Materials

| DESCRIPTION | MATERIAL |
|---------------|-------------------------------------|
| Body | Brass chrome plated CW617N EN 12165 |
| Tailpiece | Brass chrome plated CW614N EN 12164 |
| Ball | Brass chrome plated CW617N EN 12165 |
| Stem | Brass chrome plated CW614N EN 12164 |
| Ball Seat | PTFE |
| Packing | PTFE |
| Handle | Galvanized steel |
| Handle Sleeve | Vinyl |
| Handle Nut | Galvanized steel |



All data, descriptions and pictures contained in this leaflet may be subject to change without prior notice.

European Casting Industry Srl | Via Lazzaretto, 11 | 20124 Milan MI, Italia | P.Iva: 03228761205 | www.ecivalve.it | info@ecivalve.it

BS 202

BRASS STRAINER "Y" TYPE

According to PED 97/23/CE and it is CE marking-free as per art. 3 par. 3

www.ecivalve.it

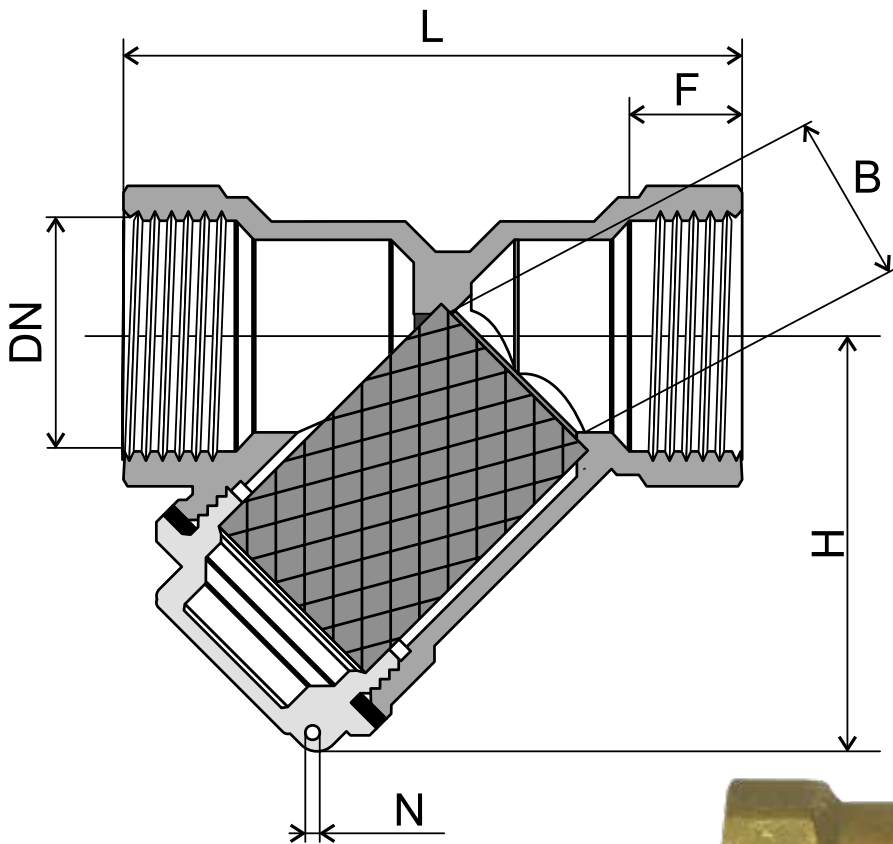

Specifications:

- WORKING PRESSURE: PN16
- WORKING TEMPERATURE: 0°C +100°C
- THREADED ACCORDING TO ISO 228/1 FXF
- SUITABLE MEDIA: WATER, OIL & AIR

Dimensions (mm)

| DN | Size (Inch) | L | H | F | N | B | Weight KGS |
|-----|-------------|-----|-----|----|---|----|------------|
| 15 | 1/2" | 56 | 40 | 11 | 2 | 15 | 0,14 |
| 20 | 3/4" | 67 | 46 | 11 | 2 | 18 | 0,18 |
| 25 | 1" | 74 | 50 | 14 | 2 | 20 | 0,31 |
| 32 | 1.1/4" | 96 | 67 | 15 | 2 | 31 | 0,50 |
| 40 | 1.1/2" | 104 | 74 | 15 | 2 | 37 | 0,73 |
| 50 | 2" | 125 | 90 | 18 | 2 | 44 | 1,19 |
| 65 | 2.1/2" | 146 | 107 | 19 | 3 | 58 | 2,17 |
| 80 | 3" | 170 | 123 | 21 | 3 | 70 | 2,70 |
| 100 | 4" | 210 | 152 | 25 | 3 | 85 | 6,40 |



Materials

| Description | Material |
|-------------|---------------------------|
| Body | Brass CW617N UNI-EN 12165 |
| Screen | Stainless Steel AISI 304 |
| Gasket | PTFE |
| Cap | Brass CW617N UNI-EN 12165 |



All data, descriptions and pictures contained in this leaflet may be subject to change without prior notice.

European Casting Industry Srl | Via Lazzaretto, 11 | 20124 Milan MI, Italia | P.Iva: 03228761205 | www.ecivalve.it | info@ecivalve.it

BS 302

BRASS CHECK VALVE
SWING TYPE

www.ecivalve.it

ECI EUROPEAN
CASTING
INDUSTRY

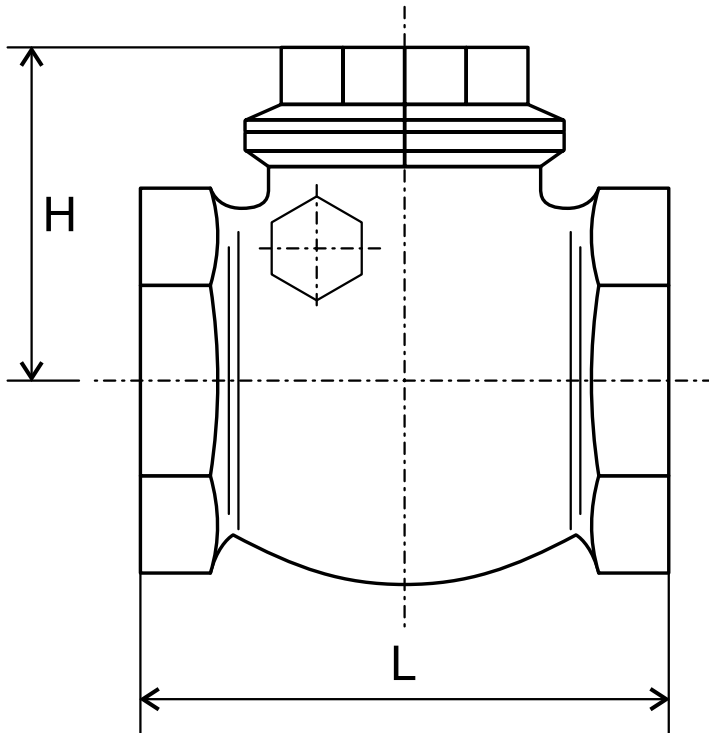

Dimensions (mm)

| DN | SIZE INCH | L | H | F | B | Weight(KGS) |
|-----|-----------|-----|-----|----|----|-------------|
| 15 | 1/2" | 47 | 51 | 8 | 15 | 0,16 |
| 20 | 3/4" | 53 | 58 | 8 | 20 | 0,20 |
| 25 | 1" | 63 | 68 | 10 | 25 | 0,35 |
| 32 | 1.1/4" | 70 | 78 | 10 | 33 | 0,42 |
| 40 | 1.1/2" | 88 | 98 | 10 | 37 | 0,76 |
| 50 | 2" | 97 | 109 | 11 | 47 | 1,00 |
| 65 | 2.1/2" | 120 | 130 | 16 | 55 | 1,65 |
| 80 | 3" | 135 | 145 | 16 | 70 | 2,30 |
| 100 | 4" | 162 | 180 | 20 | 90 | 5,10 |

Specifications:

- WORKING PRESSURE: PN 16
- WORKING TEMPERATURE: 0°C + 90°C
- METAL SEAT
- THREADING ACCORDING TO ISO 228/1
- SUITABLE FOR WATER, OIL & AIR

Materials

| DESCRIPTION | MATERIAL |
|-------------|---------------------------|
| Body | CW 617N - UNI-EN 12165/98 |
| Disc | CW 617N - UNI-EN 12165/98 |
| Disc Gasket | NBR |
| Cap Gasket | Heat resisting fiber |
| Cap | CW 617N - UNI-EN 12165/98 |

ECI EUROPEAN
CASTING
INDUSTRY

All data, descriptions and pictures contained in this leaflet may be subject to change without prior notice.

European Casting Industry Srl | Via Lazzaretto, 11 | 20124 Milan MI, Italia | P.Iva: 03228761205 | www.ecivalve.it | info@ecivalve.it

BS 501

BRASS GATE VALVE

PN 16

Non-Rising stem - FXF



www.ecivalve.it

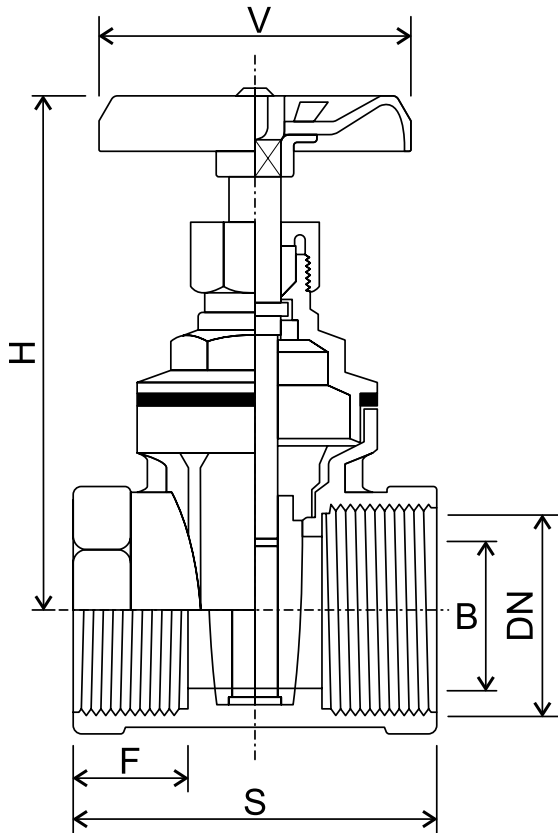

Specifications:

- PRESSURE RATING: PN16
- SUITABLE MEDIA: WATER, OIL & AIR
- WORKING TEMPERATURE: 0°C + 90°C
- ISO 288/1 THREAD FXF

Dimensions (mm)

| DN | SIZE INCH | B | F | S | H | V | Weight(KGS) |
|-----|-----------|----|----|----|-----|-----|-------------|
| 15 | 1/2" | 15 | 10 | 38 | 69 | 50 | 0,19 |
| 20 | 3/4" | 19 | 11 | 44 | 77 | 50 | 0,26 |
| 25 | 1" | 24 | 12 | 48 | 90 | 60 | 0,37 |
| 32 | 1.1/4" | 32 | 13 | 51 | 97 | 60 | 0,53 |
| 40 | 1.1/2" | 37 | 14 | 58 | 108 | 70 | 0,71 |
| 50 | 2" | 47 | 15 | 63 | 131 | 80 | 1,16 |
| 65 | 2.1/2" | 60 | 15 | 64 | 155 | 90 | 1,70 |
| 80 | 3" | 72 | 18 | 75 | 183 | 100 | 2,47 |
| 100 | 4" | 93 | 19 | 85 | 225 | 120 | 4,50 |

Materials

| DESCRIPTION | MATERIAL |
|---------------|--------------------------|
| Body | CW617N - UNI EN 12165/98 |
| Bonnet | CW617N - UNI EN 12165/98 |
| Bonnet gasket | Heat resisting fiber |
| Stem | CW614N - UNI EN 12164/98 |
| Wedge | CW617N - UNI EN 12165/98 |
| Screwed ring | CW614N - UNI EN 12164/98 |
| Packing | PTFE |
| Packing nut | CW614N - UNI EN 12164/98 |
| Handwheel | Steel blue paint |
| Nut | Steel zinc plated |



All data, descriptions and pictures contained in this leaflet may be subject to change without prior notice.

European Casting Industry Srl | Via Lazzaretto, 11 | 20124 Milan MI, Italia | P.Iva: 03228761205 | www.ecivalve.it | info@ecivalve.it

BS 502

BRASS GATE VALVE

PN 20

Non-Rising stem

Conforms to PED 97/23/CE & it is CE marking-free as per art. 3 par. 3

www.ecivalve.it

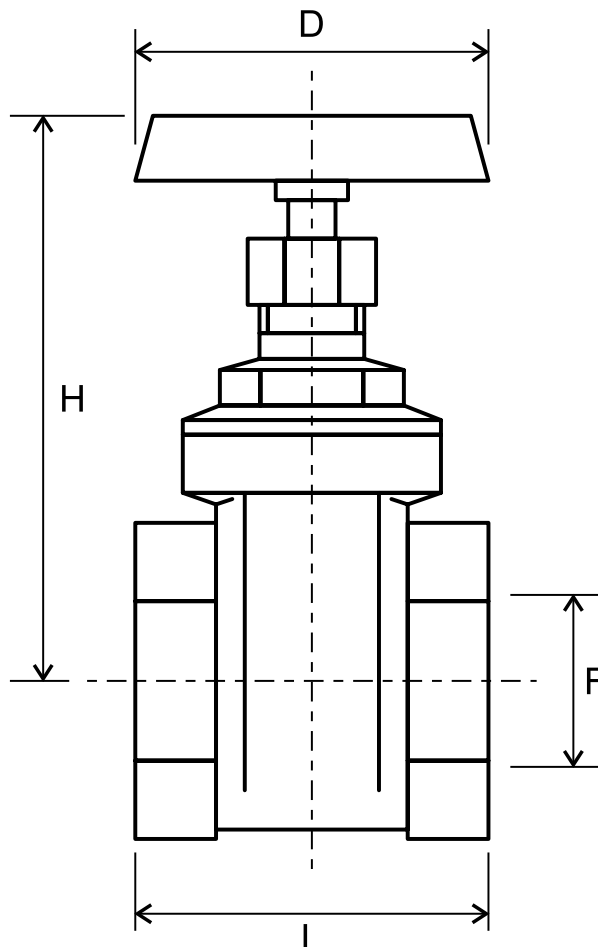

Specifications:

- PRESSURE RATING: PN20
- SUITABLE MEDIA: WATER, OIL & AIR
- WORKING TEMPERATURE: T ≤ 80°C
- TAPER PIPE THREAD TO NPT AND ISO 228/1

Dimensions (mm)

| DN | SIZE INCH | F | L | H | D | Weight(KGS) |
|-----|-----------|----|----|-----|-----|-------------|
| 15 | ½" | 15 | 43 | 68 | 45 | 0.200 |
| 20 | ¾" | 19 | 47 | 78 | 50 | 0.290 |
| 25 | 1" | 24 | 53 | 92 | 55 | 0.400 |
| 32 | 1¼" | 32 | 57 | 108 | 60 | 0.620 |
| 40 | 1½" | 37 | 61 | 125 | 70 | 0.750 |
| 50 | 2" | 47 | 67 | 143 | 80 | 1.240 |
| 65 | 2½" | 60 | 74 | 175 | 100 | 1.900 |
| 80 | 3" | 72 | 86 | 205 | 100 | 2.560 |
| 100 | 4" | 93 | 98 | 235 | 120 | 4.640 |

Materials

| DESCRIPTION | MATERIAL |
|------------------|---------------------------------|
| Body: Ø up to 2" | Brass CW 617 N-UNI-EN12165 |
| Ø 2½" to 4" | Brass DELTA C EN1982 CB 7545 |
| Bonnet | Brass CW 617 N-UNI-EN12165 |
| Stem & Gland | Brass CW 614 N-UNI-EN12164 |
| Packing | EPDM90 DUTRAL |
| Wedge | Brass DELTA C EN1982 CB 7545 |
| Handwheel | Steel with blue plastic coating |
| Handwheel Nut | Steel Zinc plated |



All data, descriptions and pictures contained in this leaflet may be subject to change without prior notice.

European Casting Industry Srl | Via Lazzaretto, 11 | 20124 Milan MI, Italia | P.Iva: 03228761205 | www.ecivalve.it | info@ecivalve.it

BS 910

BRASS AUTOMATIC AIR VENT

www.ecivalve.it

ECI EUROPEAN
CASTING
INDUSTRY

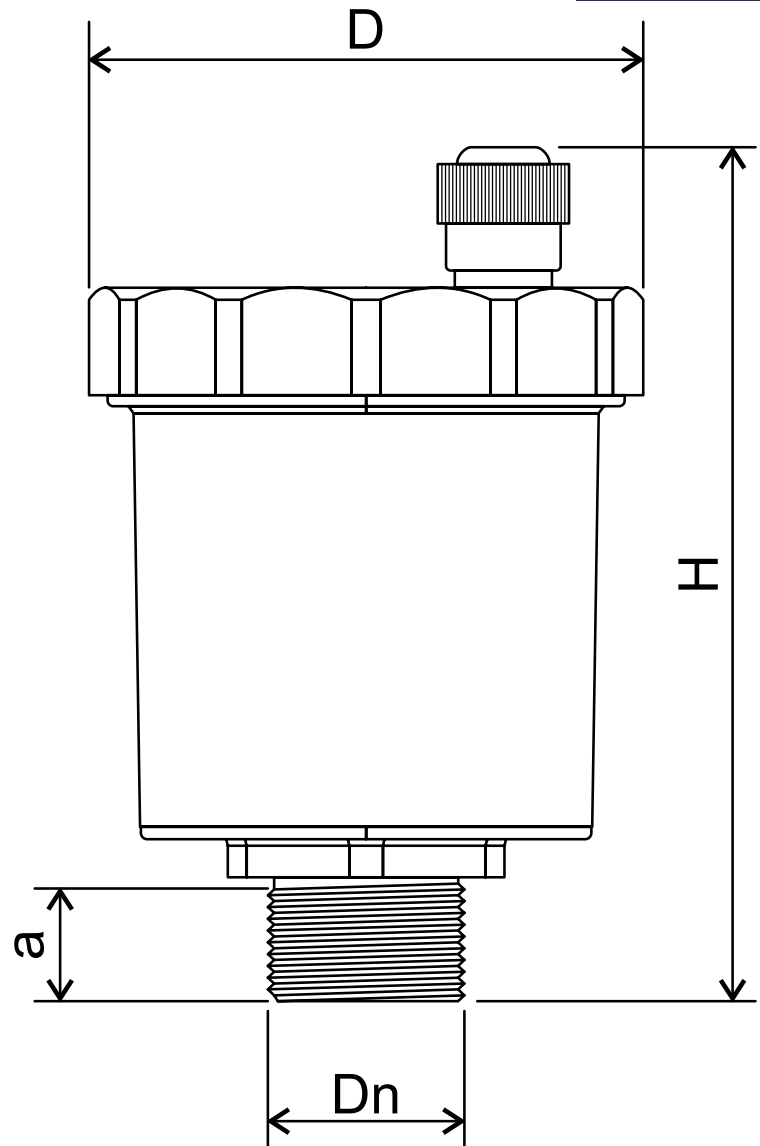

Specifications:

- WORKING PRESSURE: PN 10
- WORKING TEMPERATURE: $T \leq 110^{\circ}\text{C}$
- SINGLE AUTOMATIC FLOAT
- THREADING ACCORDING TO ISO 228/1
- SUITABLE FOR FLUID ACCORDING TO UNI 8065

Dimensions (mm)

| DN | SIZE INCH | a | D | H | Weight(KGS) |
|----|-----------|----|----|----|-------------|
| 10 | 3/8" | 9 | 46 | 70 | 0.146 |
| 15 | 1/2" | 9 | 46 | 70 | 0.157 |
| 20 | 3/4" | 9 | 46 | 70 | 0.160 |
| 25 | 1" | 13 | 46 | 70 | 0.190 |

Materials

| DESCRIPTION | MATERIAL |
|-------------|--------------------------|
| Body | Brass EN 1982-CB754S |
| Seat | Brass EN 12164-CW617N |
| Seat Gasket | NBR |
| Float | Polypropilene PP |
| Spring | Stainless Steel AISI 302 |

ECI EUROPEAN
CASTING
INDUSTRY

All data, descriptions and pictures contained in this leaflet may be subject to change without prior notice.

European Casting Industry Srl | Via Lazzaretto, 11 | 20124 Milan MI, Italia | P.Iva: 03228761205 | www.ecivalve.it | info@ecivalve.it



Cast-Iron Valves

| | |
|-------|----|
| G 101 | 29 |
| G 103 | 30 |
| G 201 | 31 |
| G 203 | 32 |
| G 301 | 33 |
| G 303 | 34 |
| G 311 | 35 |
| G 401 | 36 |
| G 403 | 37 |
| G 501 | 38 |
| G 503 | 39 |
| G 505 | 40 |
| G 507 | 41 |
| G 511 | 42 |
| G 801 | 43 |

G 101

DUCTILE IRON BUTTERFLY VALVE WAFER SEMI-LUGGED TYPE WITH LEVER

Conforms to MSS SP-67 per art. 3 par. 3

www.ecivalve.it

ECI EUROPEAN
CASTING
INDUSTRY

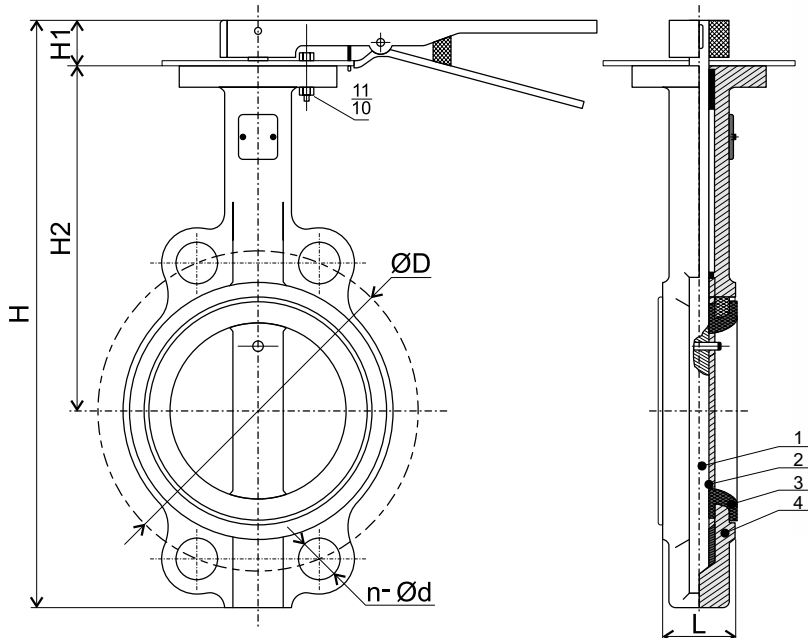

Specifications:

- WAFER SEMI-LUGGED TYPE BUTTERFLY VALVE WITH LEVER
- END CONNECTION SUITABLE FOR FLANGE CONNECTION ANSI B16.5 CLASS 150 OR PN16
- PRESSURE RATING 150 PSI
- DESIGNED & MANUFACTURED TO MEET MSS SP-67 STANDARD
- NOT SUITABLE FOR STEAM
- SUITABLE MEDIA: FRESH WATER, SEWAGE, SEA WATER, AIR, OIL, ACID & CORROSIVE MEDIA
- WORKING TEMPERATURE FROM -15 TO +120°C / -5°F TO +249°F

Materials

| No. | DESCRIPTION | MATERIAL | AMERICAN STANDARD |
|-----|-------------|-----------------|---------------------|
| 1 | Body | Ductile Iron | ASTM A 536 65-45-12 |
| 2 | Seat | EPDM | - |
| 3 | Disc | Stainless Steel | SS304/316 |
| 4 | Shaft | Stainless Steel | SS410 |

Dimensions (mm)

| DN | H | H1 | H2 | Ød | n-Ød | BOLTS | L | WEIGHT KGS |
|-----|-----|----|-----|-----|-------|------------------|------|------------|
| 50 | 273 | 32 | 161 | 121 | 4-Ø19 | 4 - 5/8" - 11UNC | 42.0 | 2.50 |
| 65 | 296 | 32 | 175 | 140 | 4-Ø19 | 4 - 5/8" - 11UNC | 45.0 | 3.10 |
| 80 | 308 | 32 | 181 | 153 | 4-Ø19 | 4 - 5/8" - 11UNC | 44.5 | 3.70 |
| 100 | 346 | 32 | 200 | 191 | 4-Ø19 | 8 - 5/8" - 11UNC | 51.0 | 5.20 |
| 125 | 372 | 32 | 213 | 216 | 4-Ø22 | 8 - 3/4" - 10UNC | 54.5 | 6.50 |
| 150 | 397 | 32 | 226 | 242 | 4-Ø22 | 8 - 3/4" - 10UNC | 54.8 | 8.50 |
| 200 | 480 | 40 | 260 | 299 | 4-Ø22 | 8 - 3/4" - 10UNC | 59.6 | 14.00 |
| 250 | 545 | 50 | 295 | 362 | 4-Ø25 | 12 - 7/8" - 9UNC | 67.0 | 21.00 |
| 300 | 634 | 55 | 310 | 432 | 4-Ø25 | 12 - 7/8" - 9UNC | 75.9 | 32.00 |

ECI EUROPEAN
CASTING
INDUSTRY

All data, descriptions and pictures contained in this leaflet may be subject to change without prior notice.

European Casting Industry Srl | Via Lazzaretto, 11 | 20124 Milan MI, Italia | P.Iva: 03228761205 | www.ecivalve.it | info@ecivalve.it

G 103

DUCTILE IRON BUTTERFLY VALVE
 WAFER SEMI-LUGGED GEAR OPERATED
 Conforms to MSS SP-67

www.ecivalve.it

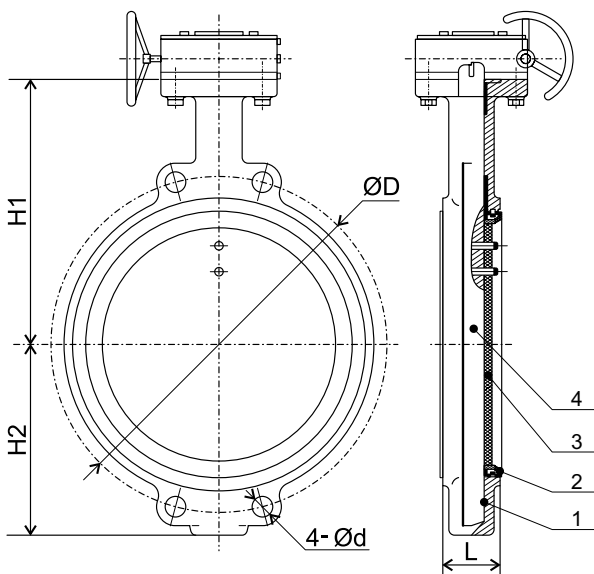

Specifications:

- WAFER SEMI-LUGGED TYPE BUTTERFLY VALVE WITH GEAR OPERATION
- END CONNECTION SUITABLE FOR FLANGE CONNECTION ANSI B16.5 CLASS 150 OR PN16
- PRESSURE RATING 150 PSI
- DESIGNED & MANUFACTURED TO MEET MSS-SP 67 STANDARD
- NOT SUITABLE FOR STEAM
- SUITABLE MEDIA: FRESH WATER, SEWAGE, SEA WATER, AIR, OIL, ACID & CORROSIVE MEDIA
- WORKING TEMPERATURE FROM -15 TO +120°C / -5°F TO +249°F

Materials

| No. | DESCRIPTION | MATERIAL | AMERICAN STANDARD |
|-----|-------------|-----------------|-------------------|
| 1 | Body | Ductile Iron | ASTM A 395 |
| 2 | Seat | EPDM | - |
| 3 | Disc | Stainless Steel | SS304/316 |
| 4 | Shaft | Stainless Steel | SS410 |

Dimensions (mm)

| DN | H1 | H2 | Ød | 4-Ød | BOLTS | L | WEIGHT KGS |
|-----|-----|-----|-----|-------|--------------------|------|------------|
| 150 | 226 | 139 | 242 | 4-Ø22 | 8 - 3/4" - 10UNC | 54.8 | 11.50 |
| 200 | 260 | 175 | 299 | 4-Ø22 | 8 - 3/4" - 10UNC | 59.6 | 19.50 |
| 250 | 292 | 203 | 362 | 4-Ø25 | 12 - 7/8" - 9UNC | 67.0 | 25.00 |
| 300 | 337 | 242 | 432 | 4-Ø25 | 12 - 7/8" - 9UNC | 75.9 | 38.00 |
| 350 | 368 | 267 | 476 | 4-Ø29 | 12 - 1" - 8UNC | 75.5 | 44.00 |
| 400 | 400 | 309 | 540 | 4-Ø29 | 16 - 1" - 8UNC | 90.0 | 72.00 |
| 450 | 422 | 327 | 578 | 4-Ø32 | 12 - 1 1/8" - 7UNC | 104 | 85.00 |



All data, descriptions and pictures contained in this leaflet may be subject to change without prior notice.

European Casting Industry Srl | Via Lazzaretto, 11 | 20124 Milan MI, Italia | P.Iva: 03228761205 | www.ecivalve.it | info@ecivalve.it

G 201

CAST IRON STRAINER, Y TYPE

CL-125 FLANGED

www.ecivalve.it

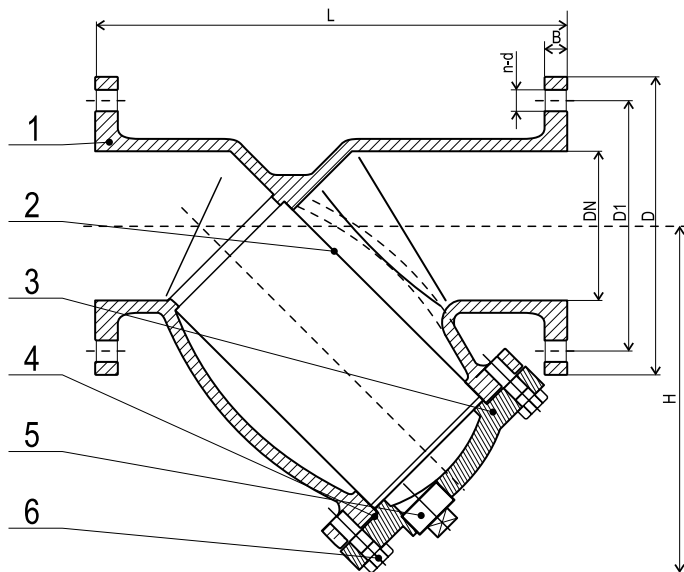

Specifications:

- 125 PSI/8.6 BAR SATURATED STEAM TO 353°F/178°C
- 200 PSI/13.8 BAR WOG FROM -10 TO 65 °C
- FLANGE DRILLED CONFORM TO ANSI B16.1 CL 125
- FACE TO FACE DIMENSION CONFORMS TO SERIES 1 OF BS EN 558-1
- SUITABLE MEDIA: WATERS, OIL, AIR & STEAM

Materials

| No. | DESCRIPTION | MATERIAL | AMERICAN STANDARD |
|-----|-------------|-----------------|-------------------|
| 1 | Body | Cast Iron | ASTM A 126 B |
| 2 | Screen | Stainless Steel | ANSI 304 |
| 3 | Bonnet | Cast Iron | ASTM A 126 B |
| 4 | Gasket | Graphite | Non Asbestos |
| 5 | Screw Plug | Brass | ASTM B584 C84400 |
| 6 | Bolt | Steel | ASTM A 307 |

Dimensions (mm)

| DN | SIZE INCH | L | D | D1 | B | f | n-d | H | WEIGHT KGS |
|-----|-----------|------|-----|-----|----|---|-------|-----|------------|
| 50 | 2 | 230 | 152 | 121 | 20 | 3 | 4-19 | 156 | 10.1 |
| 65 | 2½ | 290 | 178 | 140 | 20 | 3 | 4-19 | 176 | 14.0 |
| 80 | 3 | 310 | 190 | 153 | 22 | 3 | 4-19 | 199 | 20.3 |
| 100 | 4 | 350 | 229 | 191 | 24 | 3 | 8-19 | 240 | 26.6 |
| 125 | 5 | 400 | 254 | 216 | 26 | 3 | 8-22 | 292 | 39.8 |
| 150 | 6 | 480 | 279 | 241 | 26 | 3 | 8-22 | 320 | 57.0 |
| 200 | 8 | 600 | 343 | 299 | 30 | 3 | 8-22 | 399 | 97.0 |
| 250 | 10 | 730 | 406 | 362 | 32 | 3 | 12-25 | 516 | 163.5 |
| 300 | 12 | 850 | 483 | 432 | 32 | 4 | 12-25 | 568 | 233.5 |
| 350 | 14 | 980 | 533 | 477 | 36 | 4 | 12-29 | 648 | 312.0 |
| 400 | 16 | 1100 | 597 | 540 | 38 | 4 | 16-29 | 759 | 422.0 |



All data, descriptions and pictures contained in this leaflet may be subject to change without prior notice.

European Casting Industry Srl | Via Lazzaretto, 11 | 20124 Milan MI, Italia | P.Iva: 03228761205 | www.ecivalve.it | info@ecivalve.it

G 203

CAST IRON STRAINER, Y TYPE

PN16 Flanged

www.ecivalve.it

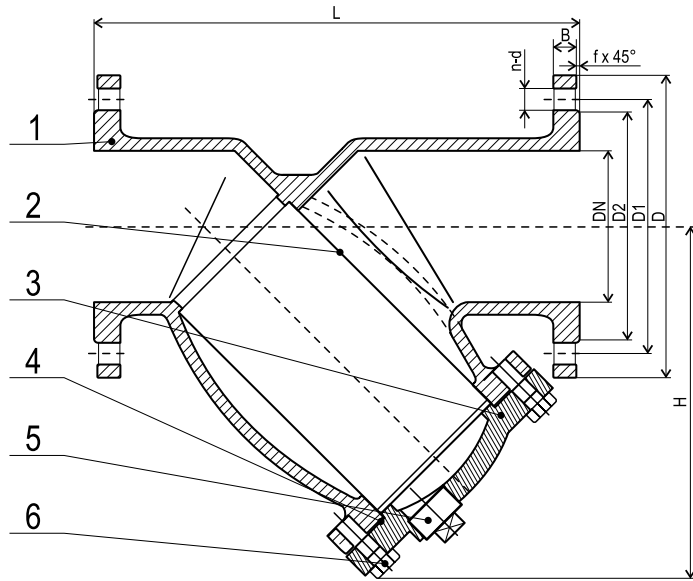

Specifications:

- 16 BAR FROM -10 TO 120 °C, 13 BAR AT 220 °C
- FLANGE DRILLED CONFORM TO BS-EN 1092-2 PN16
- FACE TO FACE DIMENSION CONFORMS TO SERIES 1 OF BS EN 558-1
- SUITABLE MEDIA: WATERS, OIL, AIR & STEAM

Materials

| No. | DESCRIPTION | MATERIAL | BRITISH STANDARD |
|-----|-------------|-----------|------------------|
| 1 | Body | Cast iron | 1561EN JL 1030 |
| 2 | Screen | Stainless | 1449304S315 |
| 3 | Bonnet | Cast Iron | 1561EN JL 1030 |
| 4 | Gasket | Graphite | Non Asbestos |
| 5 | Screw Plug | Brass | Mn Brass |
| 6 | Bolt | Steel | BS979 43A |

Dimensions (mm)

| DN | L | D | D1 | D2 | B | f | n-d | H | WEIGHT KGS |
|-----|------|-----|-----|-----|----|---|-------|-----|------------|
| 50 | 230 | 165 | 125 | 102 | 20 | 3 | 4-19 | 156 | 10.9 |
| 65 | 290 | 185 | 145 | 122 | 20 | 3 | 4-19 | 176 | 14.5 |
| 80 | 310 | 200 | 160 | 138 | 22 | 3 | 8-19 | 199 | 20.9 |
| 100 | 350 | 220 | 180 | 158 | 24 | 3 | 8-19 | 240 | 26.8 |
| 125 | 400 | 250 | 210 | 188 | 26 | 3 | 8-19 | 292 | 40.2 |
| 150 | 480 | 285 | 240 | 212 | 26 | 3 | 8-23 | 320 | 57.1 |
| 200 | 600 | 340 | 295 | 288 | 30 | 3 | 12-23 | 399 | 97.1 |
| 250 | 730 | 405 | 355 | 320 | 32 | 3 | 12-28 | 516 | 163.0 |
| 300 | 850 | 460 | 410 | 378 | 32 | 4 | 12-28 | 568 | 228.4 |
| 350 | 980 | 520 | 470 | 438 | 36 | 4 | 16-28 | 648 | 312.0 |
| 400 | 1100 | 580 | 525 | 490 | 38 | 4 | 16-31 | 759 | 422.0 |



All data, descriptions and pictures contained in this leaflet may be subject to change without prior notice.

European Casting Industry Srl | Via Lazzaretto, 11 | 20124 Milan MI, Italia | P.Iva: 03228761205 | www.ecivalve.it | info@ecivalve.it

G 301

CAST IRON SWING CHECK VALVE

CLASS 125

Conforms to MSS SP-71

www.ecivalve.it

ECI EUROPEAN
CASTING
INDUSTRY

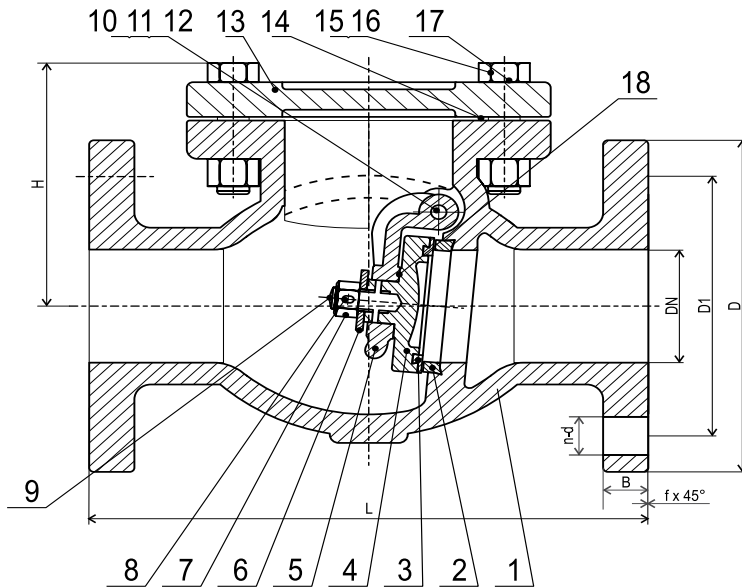

Specifications:

- 125 PSI/8.6 BAR SATURATED STEAM TO 449°F/232°C 200 PSI/13.8 BAR COLD WORKING PRESSURE FROM -20°F TO 150°F/-29°C TO 66°C
- TEST PRESSURES HYDRAULIC: BODY: 24 BAR, SEAT: 17.6 BAR
- DESIGN AND MANUFACTURE CONFORM TO MSS SP-71
- FACE TO FACE DIMENSIONS CONFORM TO ANSI B16.10
- FLANGE DRILLED CONFORMS TO ANSI B16.1 CLASS 125
- SUITABLE MEDIA: WATER & OIL
- BOLTED COVER
- SUITABLE FOR MOUNTING IN HORIZONTAL AND VERTICAL PIPELINES (WITH THE FLOW UPWARDS OR IN ANY INTERMEDIATE POSITION)

Dimensions (mm)

| DN | SIZE INCH | L | D | D1 | B | n-d | H | WEIGHT KGS |
|-----|-----------|------|-----|-----|------|-------|-----|------------|
| 50 | 2 | 203 | 152 | 121 | 15.9 | 4-19 | 112 | 10.4 |
| 65 | 2.1/2 | 216 | 178 | 140 | 17.5 | 4-19 | 132 | 14.2 |
| 80 | 3 | 241 | 190 | 153 | 19.0 | 4-19 | 141 | 19.0 |
| 100 | 4 | 292 | 229 | 191 | 23.8 | 8-19 | 162 | 33.3 |
| 125 | 5 | 330 | 254 | 216 | 23.8 | 8-22 | 192 | 49.0 |
| 150 | 6 | 356 | 279 | 241 | 25.4 | 8-22 | 211 | 63.6 |
| 200 | 8 | 495 | 343 | 299 | 28.6 | 8-22 | 270 | 112.0 |
| 250 | 10 | 622 | 406 | 362 | 30.2 | 12-25 | 316 | 189.5 |
| 300 | 12 | 698 | 483 | 432 | 31.8 | 12-25 | 357 | 247.0 |
| 350 | 14 | 787 | 533 | 477 | 34.9 | 12-29 | 560 | 419 |
| 400 | 16 | 914 | 597 | 540 | 36.5 | 16-29 | 589 | 542 |
| 450 | 18 | 914 | 635 | 578 | 39.7 | 16-32 | 645 | 656 |
| 500 | 20 | 1016 | 699 | 635 | 42.9 | 20-32 | 702 | 832 |
| 600 | 24 | 1219 | 813 | 750 | 47.6 | 20-35 | 812 | 1260 |

Materials

| No. | DESCRIPTION | MATERIAL | AMERICAN STANDARD |
|-----|----------------------|--------------------|--------------------|
| 1 | Body | Cast Iron | ASTM A 126 B |
| 2 | Seat Ring | Bronze | ASTM B 62 |
| 3 | Disc Ring | Bronze | ASTM B 62 |
| 4 | Disc | Cast Iron | ASTM A 126 B |
| 5 | Hanger | Ductile Iron | ASTM A536 60-40-18 |
| 6 | Washer | Steel | ASTM A 307 |
| 7 | Nut | Steel | ASTM A 307 |
| 8 | Split Pin | Stainless Steel | ANSI 304 |
| 9 | Disc Screw | Steel | ASTM A 307 |
| 10 | Side Pin | Brass | ASTM B584 C84400 |
| 11 | Gasket | Steel Cardboard | - |
| 12 | Hanger Pin | Stainless Steel | ANSI 304 |
| 13 | Bonnet | Cast Iron | ASTM A 126 B |
| 14 | Gasket | Graphite | Non Asbestos |
| 15 | Bolt | Steel | ASTM A 307 |
| 16 | Nut | Steel | ASTM A 307 |
| 17 | Identification Plate | Aluminum | - |
| 18 | Pin | Stainless Steel | ANSI 304 |

ECI EUROPEAN
CASTING
INDUSTRY

All data, descriptions and pictures contained in this leaflet may be subject to change without prior notice.

European Casting Industry Srl | Via Lazzaretto, 11 | 20124 Milan MI, Italia | P.Iva: 03228761205 | www.ecivalve.it | info@ecivalve.it

G 303

CAST IRON SWING CHECK VALVE

BS PN16

Conforms to BS EN 12334:2001

www.ecivalve.it

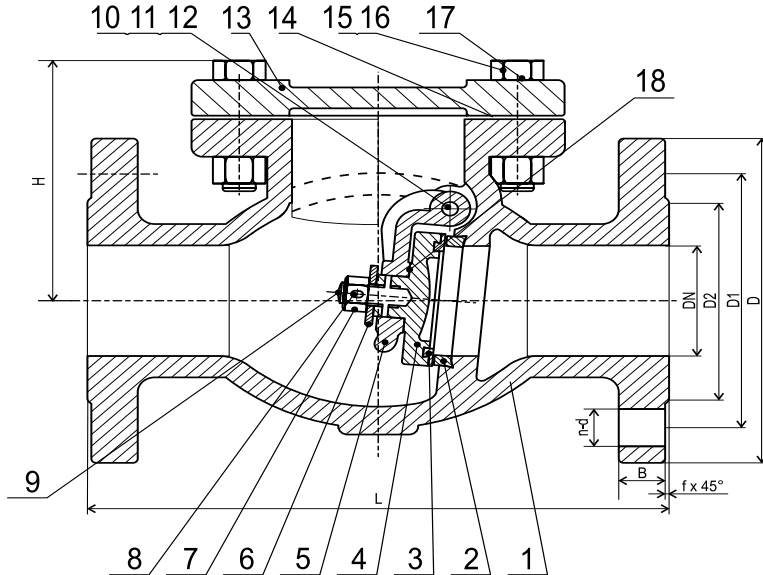

Specifications:

- PRESSURE-TEMPERATURE RATING: BS EN 1092-2 PN16 16 BAR FROM -10 TO 120°C 13 BAR AT 220°C
- TEST PRESSURES HYDRAULIC: BODY: 24 BAR, SEAT: 17.6 BAR
- DESIGN AND MANUFACTURE CONFORM TO BS5153 & BS EN 12334:2001
- FACE TO FACE DIMENSIONS CONFORM TO SERIES 10 OF BS EN 558 - 1
- FLANGE DRILLED CONFORMS TO BS EN 1092-2 PN16
- SUITABLE MEDIA: WATER & OIL
- BOLTED COVER
- SUITABLE FOR MOUNTING IN HORIZONTAL AND VERTICAL PIPELINES (WITH THE FLOW UPWARDS OR IN ANY INTERMEDIATE POSITION)

Dimensions (mm)

| DN | L | D | D1 | D2 | B | n-d | F | H | WEIGHT KGS |
|-----|------|-----|-----|-----|----|-------|---|-----|------------|
| 50 | 203 | 165 | 125 | 102 | 20 | 4-19 | 3 | 112 | 11.2 |
| 65 | 216 | 185 | 145 | 122 | 20 | 4-19 | 3 | 132 | 14.4 |
| 80 | 241 | 200 | 160 | 138 | 22 | 8-19 | 3 | 141 | 20.0 |
| 100 | 292 | 220 | 180 | 158 | 24 | 8-19 | 3 | 162 | 31.5 |
| 125 | 330 | 250 | 210 | 188 | 26 | 8-19 | 3 | 192 | 47.0 |
| 150 | 356 | 285 | 240 | 212 | 26 | 8-23 | 3 | 211 | 63.5 |
| 200 | 495 | 340 | 295 | 288 | 30 | 12-23 | 3 | 270 | 106.4 |
| 250 | 622 | 405 | 355 | 320 | 32 | 12-28 | 3 | 316 | 184.5 |
| 300 | 698 | 460 | 410 | 378 | 32 | 12-28 | 4 | 357 | 238.5 |
| 350 | 787 | 520 | 470 | 438 | 36 | 16-28 | 4 | 560 | 419 |
| 400 | 914 | 580 | 525 | 490 | 38 | 16-31 | 4 | 589 | 542 |
| 450 | 914 | 640 | 585 | 550 | 40 | 20-31 | 4 | 645 | 656 |
| 500 | 1016 | 715 | 650 | 610 | 42 | 20-34 | 4 | 702 | 832 |
| 600 | 1219 | 840 | 770 | 725 | 48 | 20-37 | 5 | 812 | 1260 |

Materials

| No. | DESCRIPTION | MATERIAL | BRITISH STANDARD |
|-----|----------------|-----------------|------------------|
| 1 | Body | Cast Iron | 1561 EN JL 1030 |
| 2 | Seat Ring | Bronze | 1982 CC491K |
| 3 | Disc Ring | Bronze | 1982 CC491K |
| 4 | Disc | Cast Iron | 1561 EN JL 1030 |
| 5 | Hanger | Ductile Iron | BS2789 Gr420-12 |
| 6 | Washer | Steel | BS970 43A |
| 7 | Nut | Steel | BS970 43A |
| 8 | Split Pin | Stainless Steel | 1449 304S315 |
| 9 | Disc Screw | Steel | BS970 43A |
| 10 | Side Pin | Brass | Mn Brass |
| 11 | Gasket | Cardboard | - |
| 12 | Hanger Pin | Stainless Steel | 1449 304S315 |
| 13 | Bonnet | Cast Iron | 1561 EN JL 1030 |
| 14 | Gasket | Graphite | Non Asbestos |
| 15 | Bolt | Steel | BS970 43A |
| 16 | Nut | Steel | BS970 43A |
| 17 | Identification | Aluminum | - |
| 18 | Pin | Stainless Steel | 1449 304S315 |



All data, descriptions and pictures contained in this leaflet may be subject to change without prior notice.

European Casting Industry Srl | Via Lazzaretto, 11 | 20124 Milan MI, Italia | P.Iva: 03228761205 | www.ecivalve.it | info@ecivalve.it

G 311

CAST IRON CHECK VALVE WAFER TYPE

ANSI 125 WP & PN 16

Conforms to MSS SP-125

www.ecivalve.it

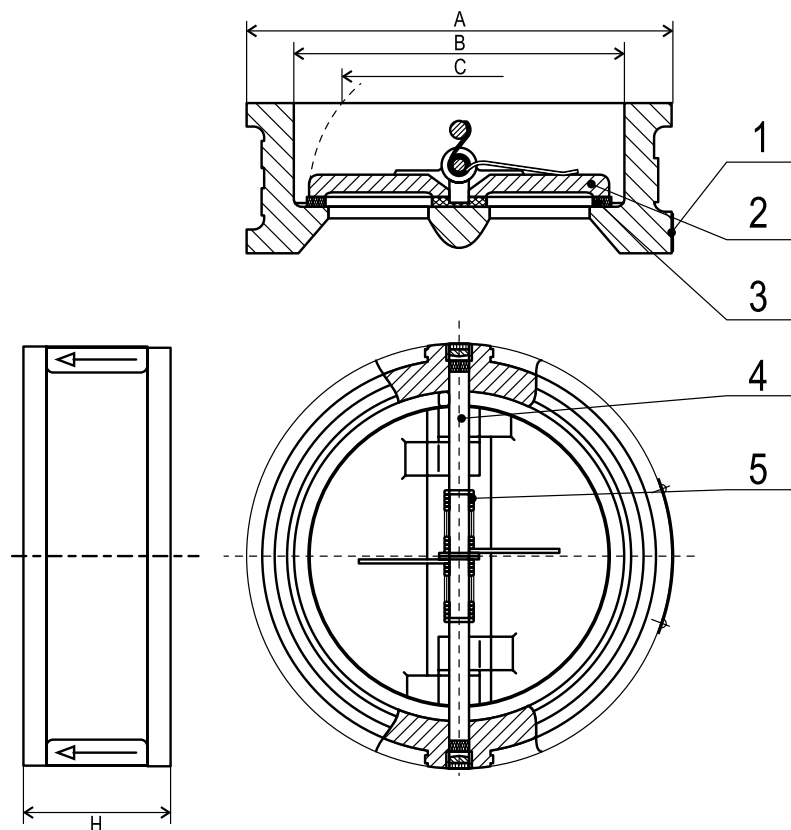

Specifications:

- PRESSURE RATING ANSI 125
- END CONNECTION SUITABLE FOR FLANGE CONNECTION ANSI B16.1 125 OR EN 1092-2 PN16
- USE ONLY FLAT FLANGES AND RING GASKETS
- FACE TO FACE DIMENSIONS CONFORM TO BS EN 558 SERIES 16
- TEMPERATURE OPERATING RANGE -20 TO 120°C
- SUITABLE FOR INSTALLATION IN VERTICAL AND HORIZONTAL PIPELINES
- IN VERTICAL PIPELINES, THE FLOW MUST BE IN AN UPWARD DIRECTION
- NOT SUITABLE FOR STEAM
- SUITABLE MEDIA: WATER, AIR, OIL, ACID AND CORROSIVE MEDIA

Material

| No. | DESCRIPTION | MATERIAL | AMERICAN STANDARD |
|-----|----------------------------------|---------------------------|------------------------------------|
| 1 | Body: Up to 12" 14" to 18" | Cast Iron Ductile Iron | ASTM A 126 B ASTM A536 65-45-12 |
| 2 | Disc | Stainless Steel | SS304/SS316 |
| 3 | Liner | EPDM | - |
| 4 | Shaft | Stainless Steel | SS410 |
| 5 | Spring | Stainless Steel | SS316 |

Dimensions (mm)

| DN | SIZE INCH | A | B | C | H | WEIGHT KGS |
|-----|-----------|-----|-----|------|-----|------------|
| 50 | 2 | 105 | 65 | 42.5 | 54 | 1.5 |
| 65 | 2½ | 124 | 80 | 59.9 | 54 | 2.0 |
| 80 | 3 | 137 | 94 | 62.6 | 57 | 2.8 |
| 100 | 4 | 175 | 117 | 84.2 | 64 | 4.1 |
| 125 | 5 | 197 | 145 | 113 | 70 | 6.4 |
| 150 | 6 | 222 | 170 | 141 | 76 | 8.5 |
| 200 | 8 | 279 | 224 | 194 | 95 | 13.5 |
| 250 | 10 | 340 | 265 | 229 | 108 | 22.0 |
| 300 | 12 | 410 | 310 | 279 | 143 | 30.0 |
| 350 | 14 | 451 | 360 | 312 | 184 | 61.0 |
| 400 | 16 | 514 | 410 | 370 | 191 | 78.0 |
| 450 | 18 | 546 | 450 | 414 | 203 | 100.0 |



All data, descriptions and pictures contained in this leaflet may be subject to change without prior notice.

European Casting Industry Srl | Via Lazzaretto, 11 | 20124 Milan MI, Italia | P.Iva: 03228761205 | www.ecivalve.it | info@ecivalve.it

G 401

CAST IRON GLOBE VALVE
ANSI CL 125 FLANGED
OUTSIDE SCREW & YOKE
CONFORMS TO MSS SP-85

www.ecivalve.it

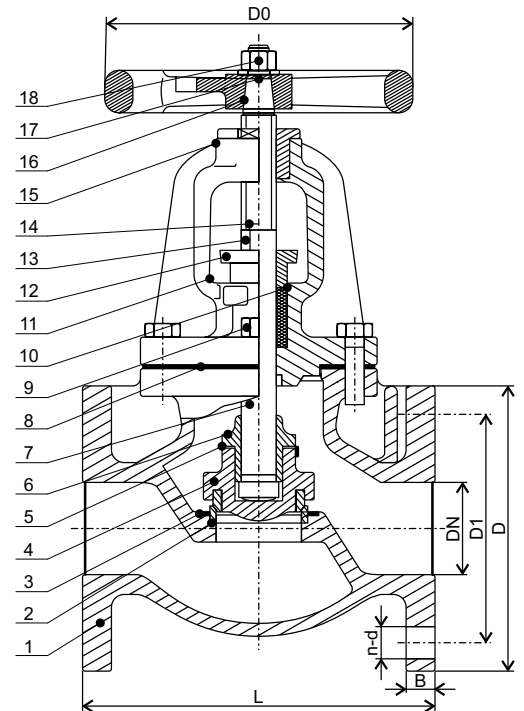

Specifications:

- OUTSIDE SCREW & YOKE
- 125 PSI/8.6 BAR FLUID PRESSURE TO 384°F/230°C
- 200 PSI/13.8 BAR NON-SHOCK COLD WORKING PRESSURE FROM -20°F TO 150°F/ -29°C TO 66°C
- SUITABLE MEDIA: WATER, OIL, AIR & STEAM
- DESIGN AND MANUFACTURE CONFORM TO MSS SP-85
- FACE TO FACE DIMENSIONS CONFORM TO ANSI B16.10
- FLANGE DRILLED CONFORM TO ANSI B16.1 CLASS 125

Dimensions (mm)

| DN | NCH | L | D | D1 | n-d | B | Do | WEIGHT KGS |
|-----|-----|-----|-----|-----|-------|------|-----|------------|
| 50 | 2 | 203 | 152 | 121 | 4-19 | 15.9 | 180 | 15.6 |
| 65 | 2½ | 216 | 178 | 140 | 4-19 | 17.5 | 180 | 21.5 |
| 80 | 3 | 241 | 190 | 153 | 4-19 | 19.1 | 200 | 30.9 |
| 100 | 4 | 292 | 229 | 191 | 8-19 | 23.9 | 254 | 46.8 |
| 125 | 5 | 330 | 254 | 216 | 8-22 | 23.9 | 254 | 68.4 |
| 150 | 6 | 356 | 279 | 241 | 8-22 | 25.4 | 300 | 92.6 |
| 200 | 8 | 495 | 343 | 299 | 8-22 | 28.6 | 300 | 157 |
| 250 | 10 | 622 | 406 | 362 | 12-25 | 30.2 | 350 | 229 |
| 300 | 12 | 698 | 483 | 432 | 12-25 | 31.8 | 400 | 318 |

Materials

| No. | DESCRIPTION | MATERIAL | AMERICAN STANDARD |
|-----|------------------|-----------------|--------------------|
| 1 | Body | Cast Iron | ASTM A 126 B |
| 2 | Body Seat Ring | Bronze | ASTM B 62 |
| 3 | Disc Seat Ring | Bronze | ASTM B 62 |
| 4 | Disc | Cast Iron | ASTM A 126 B |
| 5 | Disc Washer | Stainless Steel | ANSI 304 |
| 6 | Disc Nut | Stainless Steel | ANSI 304 |
| 7 | Stem | Stainless Steel | ANSI 304 |
| 8 | Gasket | Graphite | Non Asbestos |
| 9 | Bolt | Steel | ASTM A 307 |
| 10 | Packing | Graphite | Non Asbestos |
| 11 | Bonnet | Cast Iron | ASTM A 126 B |
| 12 | Gland Flange | Ductile Iron | ASTM A536 60-40-18 |
| 13 | Nut | Steel | ASTM A 307 |
| 14 | Bolt | Steel | ASTM A 307 |
| 15 | Stem Nut | Brass | ASTM B584 C84400 |
| 16 | Handwheel | Cast Iron | ASTM A 126 B |
| 17 | Handwheel Washer | Steel | ASTM A 307 |
| 18 | Handwheel Nut | Steel | ASTM A 307 |



All data, descriptions and pictures contained in this leaflet may be subject to change without prior notice.

European Casting Industry Srl | Via Lazzaretto, 11 | 20124 Milan MI, Italia | P.Iva: 03228761205 | www.ecivalve.it | info@ecivalve.it

G 403

CAST IRON GLOBE VALVE

BS PN16 FLANGED

Rising stem

Conforms to BS EN 13789:2010

www.ecivalve.it

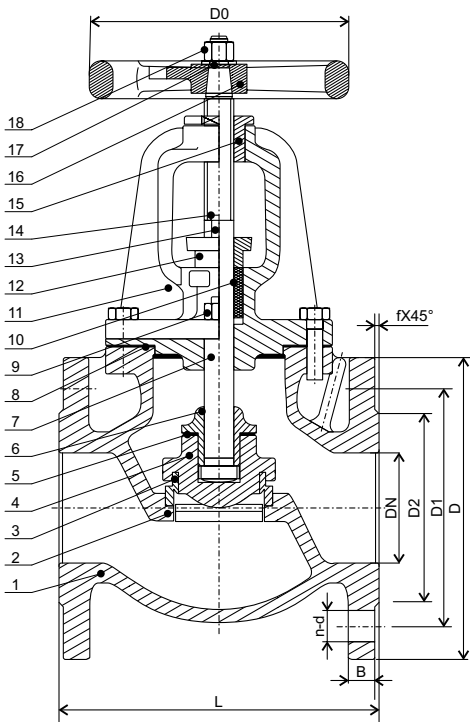

Specifications:

- OUTSIDE SCREW & YOKE
- PRESSURE-TEMPERATURE RATING: 16 BAR AT -10 TO 120°C 12.1 BAR AT 230°C
- TEST PRESSURES HYDRAULIC: SHELL: 24 BAR, SEAT: 17.6 BAR
- DESIGN AND MANUFACTURE CONFORM TO BS5152 (BS EN 13789:2010 PN16)
- FACE TO FACE DIMENSIONS CONFORM TO SERIES 10 OF BS EN 558-1
- FLANGE DRILLED CONFORM TO BS EN 1092-2 PN16
- GATE VALVES ARE DESIGNED TO BE IN AN OPEN OR CLOSED POSITION
- SUITABLE MEDIA: WATER, OIL, AIR & STEAM

Dimensions (mm)

| DN | L | D | D1 | D2 | n-d | B | f | Do | WEIGHT KGS |
|-----|-----|-----|-----|-----|-------|----|---|-----|------------|
| 50 | 203 | 165 | 125 | 102 | 4-19 | 20 | 3 | 180 | 16.4 |
| 65 | 216 | 185 | 145 | 122 | 4-19 | 20 | 3 | 180 | 22.0 |
| 80 | 241 | 200 | 160 | 138 | 8-19 | 22 | 3 | 200 | 31.5 |
| 100 | 292 | 220 | 180 | 158 | 8-19 | 24 | 3 | 254 | 46.0 |
| 125 | 330 | 250 | 210 | 188 | 8-19 | 26 | 3 | 254 | 68.7 |
| 150 | 356 | 285 | 240 | 212 | 8-23 | 26 | 3 | 300 | 92.8 |
| 200 | 495 | 340 | 295 | 288 | 12-23 | 30 | 3 | 300 | 157 |
| 250 | 622 | 405 | 355 | 320 | 12-28 | 32 | 3 | 350 | 228 |
| 300 | 698 | 460 | 410 | 378 | 12-28 | 32 | 4 | 400 | 313 |

Materials

| No. | DESCRIPTION | MATERIAL | BRITISH STANDARD |
|-----|------------------|-----------------|------------------|
| 1 | Body | Cast Iron | 1561 EN JL 1030 |
| 2 | Body Seat Ring | Bronze | 1982 CC 491K |
| 3 | Disc Seat Ring | Bronze | 1982 CC 491K |
| 4 | Disc | Cast Iron | 1561 EN JL 1030 |
| 5 | Disc Washer | Stainless Steel | 1449 304S315 |
| 6 | Nut | Brass | 12164 CW603R |
| 7 | Stem | Stainless Steel | 1449 304S315 |
| 8 | Flange Gasket | Graphite | Non Asbestos |
| 9 | Bolt | Steel | BS970 43A |
| 10 | Packing | Graphite | Non Asbestos |
| 11 | Bonnet | Cast Iron | 1561 EN JL 1030 |
| 12 | Gland | Ductile Iron | BS2789 Gr.420-12 |
| 13 | Nut | Steel | BS970 43A |
| 14 | Bolt | Steel | BS970 43A |
| 15 | Stem | Brass | 12164 CW603R |
| 16 | Handwheel | Cast Iron | 1561 EN JL 1030 |
| 17 | Handwheel Washer | Steel | BS970 43A |
| 18 | Handwheel Nut | Steel | BS970 43A |



All data, descriptions and pictures contained in this leaflet may be subject to change without prior notice.

European Casting Industry Srl | Via Lazzaretto, 11 | 20124 Milan MI, Italia | P.Iva: 03228761205 | www.ecivalve.it | info@ecivalve.it

G 501

CAST IRON GATE VALVE

ANSI CL 125 FLANGED

Non-Rising stem

Conforms to MSS SP-70

www.ecivalve.it

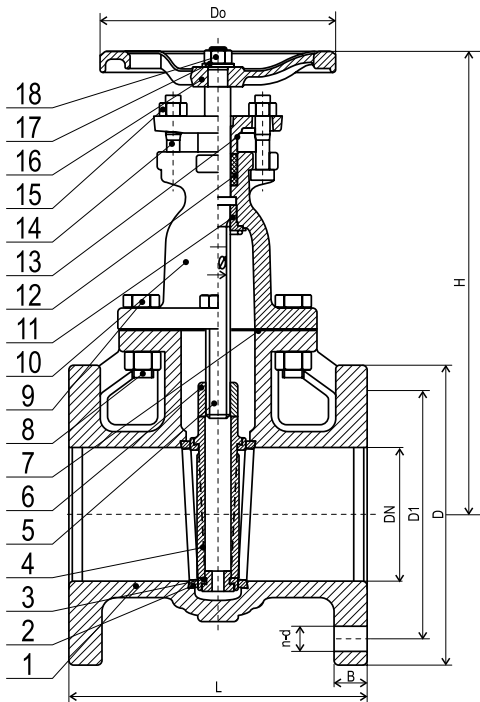

Specifications:

- INSIDE SCREW NON-RISING STEM
- 125 PSI/8.6 BAR FLUID PRESSURE TO 353°F/178°C
- 200 PSI/13.8 BAR NON-SHOCK COLD WORKING PRESSURE FROM -20°F TO 150°F/-29°C TO 66°C
- SUITABLE MEDIA: WATER & OIL
- DESIGN AND MANUFACTURE CONFORM TO MSS SP-70
- FACE TO FACE DIMENSIONS CONFORM TO ANSI B16.10
- FLANGE DRILLED CONFORM TO ANSI B16.1 CLASS 125
- GATE VALVES ARE DESIGNED TO BE IN AN OPEN OR CLOSED POSITION

Dimensions (mm)

| DN | SIZE INCH | L | D | D1 | n-d | B | Do | H | WEIGHT KG |
|-----|-----------|-------|-------|-------|---------|------|-----|------|-----------|
| 50 | 2 | 178 | 152 | 121 | 4-19 | 15.9 | 180 | 240 | 12.0 |
| 65 | 2½ | 190 | 178 | 140 | 4-19 | 17.5 | 180 | 265 | 15.4 |
| 80 | 3 | 203 | 190 | 153 | 4-19 | 19.1 | 200 | 323 | 22.6 |
| 100 | 4 | 229 | 229 | 191 | 8-19 | 23.9 | 254 | 365 | 35.8 |
| 125 | 5 | 254 | 254 | 216 | 8-22 | 23.9 | 254 | 413 | 47.6 |
| 150 | 6 | 267 | 279 | 241 | 8-22 | 25.4 | 300 | 477 | 63.0 |
| 200 | 8 | 292 | 343 | 299 | 8-22 | 28.6 | 300 | 585 | 106 |
| 250 | 10 | 330 | 406 | 362 | 12-25 | 30.2 | 350 | 710 | 168 |
| 300 | 12 | 356 | 483 | 432 | 12-25 | 31.8 | 400 | 789 | 243 |
| 350 | 14" | 381 | 533.4 | 476.3 | 12-28.6 | 34.9 | 560 | 987 | 391 |
| 400 | 16" | 406.4 | 597 | 539.8 | 16-28.6 | 36.5 | 560 | 1044 | 520 |
| 450 | 18" | 432 | 635 | 578 | 16-32 | 39.7 | 610 | 1148 | 684 |
| 500 | 20" | 457 | 699 | 635 | 20-32 | 42.9 | 610 | 1257 | 800 |
| 600 | 24" | 508 | 813 | 749.5 | 20-35 | 47.6 | 765 | 1418 | 1205 |

Materials

| No. | DESCRIPTION | MATERIAL | AMERICAN STANDARD |
|-----|-----------------|--------------|--------------------|
| 1 | Body | Cast Iron | ASTM A 126 B |
| 2 | Body Seat Ring | Bronze | ASTM B 62 |
| 3 | Wedge Seat Ring | Bronze | ASTM B 62 |
| 4 | Wedge | Cast Iron | ASTM A 126 B |
| 5 | Stem | Brass | ASTM B 16 |
| 6 | Stem Nut | Brass | ASTM B584 C84400 |
| 7 | Gasket | Graphite | Non Asbestos |
| 8 | Bolt | Steel | ASTM A 307 |
| 9 | Nut | Steel | ASTM A 307 |
| 10 | Bonnet | Cast Iron | ASTM A 126 B |
| 11 | Bonnet Bush | Brass | ASTM B584 C84400 |
| 12 | Packing | Graphite | Non Asbestos |
| 13 | Gland Follower | Ductile Iron | ASTM A536 60-40-18 |
| 14 | Bolt | Steel | ASTM A 307 |
| 15 | Nut | Steel | ASTM A 307 |
| 16 | Handwheel | Cast Iron | ASTM A 126 |
| 17 | Washer | Steel | ASTM A 307 |
| 18 | Handwheel Nut | Steel | ASTM A 307 |



All data, descriptions and pictures contained in this leaflet may be subject to change without prior notice.

European Casting Industry Srl | Via Lazzaretto, 11 | 20124 Milan MI, Italia | P.Iva: 03228761205 | www.ecivalve.it | info@ecivalve.it

G 503

CAST IRON GATE VALVE

BS PN16 FLANGED

Non-Rising stem

Conforms to BS EN 1171:2002 PN16

www.ecivalve.it

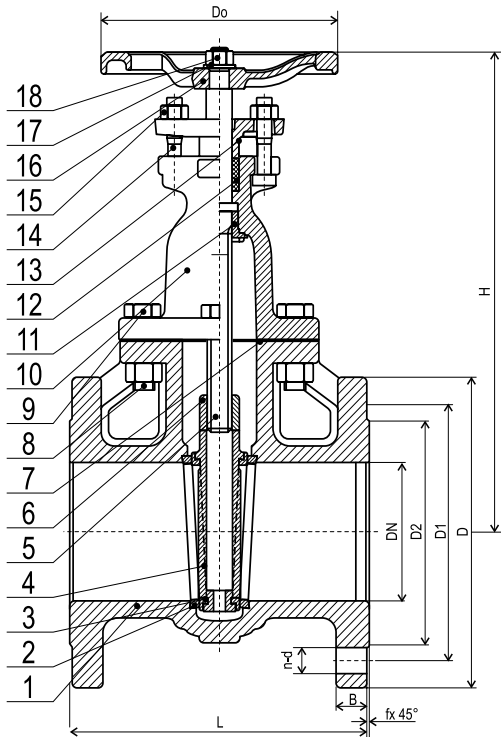

Specifications:

- PRESSURE-TEMPERATURE RATING: 16 BAR AT -10 TO 120°C 12.8 BAR AT 200°C
- TEST PRESSURES HYDRAULIC: SHELL: 24 BAR, SEAT: 17.6 BAR
- DESIGN AND MANUFACTURE CONFORM TO BS5150 (BS EN 1171:2002 PN 16)
- FACE TO FACE DIMENSIONS CONFORM TO SERIES 3 OF BS EN 558-1
- FLANGE DRILLED CONFORM TO BS EN 1092-2 PN 16
- GATE VALVES ARE DESIGNED TO BE IN AN OPEN OR CLOSED POSITION
- SUITABLE MEDIA: WATER & OIL

Dimensions (mm)

| DN | L | D | D1 | D2 | n-d | B | f | Do | H | WEIGHT KGS |
|-----|-------|-----|-----|-----|-------|----|---|-----|------|------------|
| 50 | 178 | 165 | 125 | 102 | 4-19 | 20 | 3 | 180 | 240 | 13.5 |
| 65 | 190 | 185 | 145 | 122 | 4-19 | 20 | 3 | 180 | 265 | 16.7 |
| 80 | 203 | 200 | 160 | 138 | 8-19 | 22 | 3 | 200 | 323 | 23.3 |
| 100 | 229 | 220 | 180 | 158 | 8-19 | 24 | 3 | 254 | 365 | 35.9 |
| 125 | 254 | 250 | 210 | 188 | 8-19 | 26 | 3 | 254 | 413 | 48.5 |
| 150 | 267 | 285 | 240 | 212 | 8-23 | 26 | 3 | 300 | 477 | 66.5 |
| 200 | 292 | 340 | 295 | 288 | 12-23 | 30 | 3 | 300 | 585 | 102 |
| 250 | 330 | 405 | 355 | 320 | 12-28 | 32 | 3 | 350 | 710 | 174 |
| 300 | 356 | 460 | 410 | 378 | 12-28 | 32 | 4 | 400 | 789 | 230 |
| 350 | 381 | 520 | 470 | 429 | 16-28 | 36 | 4 | 560 | 987 | 420 |
| 400 | 406.4 | 580 | 525 | 480 | 16-31 | 38 | 4 | 560 | 1044 | 598 |
| 450 | 432 | 640 | 585 | 548 | 20-31 | 40 | 4 | 610 | 1148 | 733 |
| 500 | 457 | 715 | 650 | 609 | 20-34 | 42 | 4 | 610 | 1257 | 937 |
| 600 | 508 | 840 | 770 | 720 | 20-37 | 48 | 5 | 765 | 1418 | 1211 |

Materials

| No. | DESCRIPTION | MATERIAL | BRITISH STANDARD |
|-----|------------------|--------------|------------------|
| 1 | Body | Cast iron | 1561 EN JL 1030 |
| 2 | Body Seat Ring | Bronze | 1982 CC 491K |
| 3 | Wedge Seat Ring | Bronze | 1982 CC 491K |
| 4 | Wedge | Cast Iron | 1561 EN JL 1030 |
| 5 | Stem | Brass | 12164 CW603R |
| 6 | Stem Nut | Brass | Mn Brass |
| 7 | Gasket | Graphite | Non Asbestos |
| 8 | Bolt | Steel | BS970 43A |
| 9 | Nut | Steel | BS970 43A |
| 10 | Bonnet | Cast Iron | 1561 EN JL 1030 |
| 11 | Bonnet Bush | Brass | Mn Brass |
| 12 | Packing | Graphite | Non Asbestos |
| 13 | Gland Follower | Ductile Iron | BS2789 Gr.420-12 |
| 14 | Bolt | Steel | BS970 43A |
| 15 | Nut | Steel | BS970 43A |
| 16 | Handwheel | Cast Iron | 1561 EN JL 1030 |
| 17 | Handwheel Washer | Steel | BS970 43A |
| 18 | Handwheel Nut | Steel | BS970 43A |



All data, descriptions and pictures contained in this leaflet may be subject to change without prior notice.

European Casting Industry Srl | Via Lazzaretto, 11 | 20124 Milan MI, Italia | P.Iva: 03228761205 | www.ecivalve.it | info@ecivalve.it

G 505

CAST IRON GATE VALVE

ANSI CL 125 FLANGED

Rising stem

Conforms to MSS SP-70

www.ecivalve.it

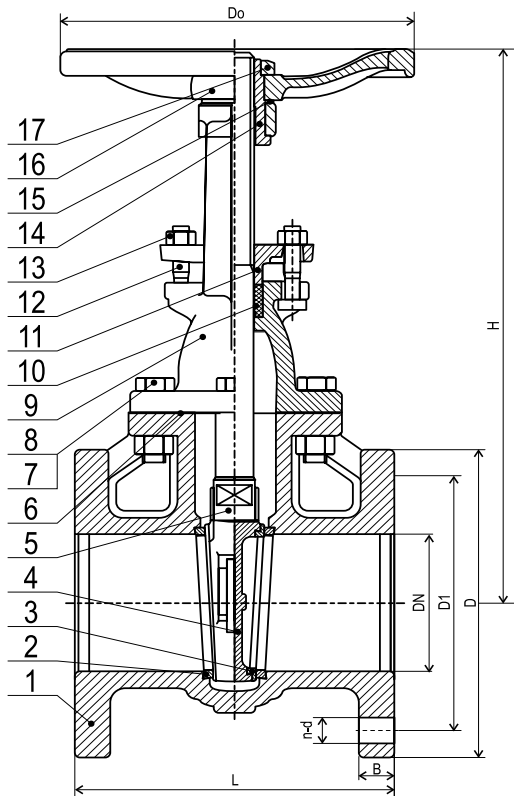

Specifications:

- OUTSIDE SCREW & YOKE
- 125 PSI/8.6 BAR FLUID PRESSURE TO 353°F/178°C
- 200 PSI/13.8 BAR NON-SHOCK COLD WORKING PRESSURE FROM -20°F TO 150°F/-29°C TO 66°C
- TEST PRESSURE SHELL 24.1 BAR & SEAT 13.8 BAR
- SUITABLE MEDIUM: WATER & OIL
- DESIGN AND MANUFACTURE CONFORM TO MSS SP-70
- FACE TO FACE DIMENSIONS CONFORM TO ANSI B16.10
- FLANGE DIMENSIONS CONFORM TO ANSI B16.1 CLASS 125
- GATE VALVES ARE DESIGNED TO BE IN AN OPEN OR CLOSED POSITION

Materials

| No. | DESCRIPTION | MATERIAL | AMERICAN STANDARD |
|-----|------------------|--------------|--------------------|
| 1 | Body | Cast iron | ASTM A 126 B |
| 2 | Body Seat Ring | Bronze | ASTM B 62 |
| 3 | Wedge Seat Ring | Bronze | ASTM B 62 |
| 4 | Wedge | Cast Iron | ASTM A 126 B |
| 5 | Stem | Brass | ASTM B 16 |
| 6 | Gasket | Graphite | Non-Asbestos |
| 7 | Bolt | Steel | ASTM 307 |
| 8 | Nut | Steel | ASTM 307 |
| 9 | Bonnet | Cast Iron | ASTM A 126 B |
| 10 | Packing | Graphite | Non-Asbestos |
| 11 | Gland Follower | Ductile Iron | ASTM A536 60-40-18 |
| 12 | Bolt | Steel | ASTM 307 |
| 13 | Nut | Steel | ASTM 307 |
| 14 | Stem Nut | Brass | ASTM B584 C884400 |
| 15 | Handwheel Washer | Brass | ASTM B584 C884400 |
| 16 | Handwheel | Cast Iron | ASTM A 126 B |
| 17 | Handwheel Nut | Steel | ASTM 307 |

Dimensions (mm)

| DN | SIZE INCH | L | D | D1 | n-d | B | Do | H CLOSED | WEIGHT KG |
|-----|-----------|-----|-----|-----|-------|------|-----|----------|-----------|
| 50 | 2 | 178 | 152 | 121 | 4-19 | 15.9 | 180 | 258 | 13.1 |
| 65 | 2½ | 190 | 178 | 140 | 4-19 | 17.5 | 180 | 302 | 17.4 |
| 80 | 3 | 203 | 190 | 153 | 4-19 | 19.1 | 200 | 341 | 22.8 |
| 100 | 4 | 229 | 229 | 191 | 8-19 | 23.9 | 254 | 415 | 37.5 |
| 125 | 5 | 254 | 254 | 216 | 8-22 | 23.9 | 254 | 484 | 48.0 |
| 150 | 6 | 267 | 279 | 241 | 8-22 | 25.4 | 300 | 560 | 64.7 |
| 200 | 8 | 292 | 343 | 299 | 8-22 | 28.6 | 300 | 703 | 106.0 |
| 250 | 10 | 330 | 406 | 362 | 12-25 | 30.2 | 350 | 865 | 178.2 |
| 300 | 12 | 356 | 483 | 432 | 12-25 | 31.8 | 400 | 1028 | 266.9 |



All data, descriptions and pictures contained in this leaflet may be subject to change without prior notice.

European Casting Industry Srl | Via Lazzaretto, 11 | 20124 Milan MI, Italia | P.Iva: 03228761205 | www.ecivalve.it | info@ecivalve.it

G 507

CAST IRON GATE VALVE

PN 16 FLANGED

RISING STEM

Conforms to BS EN 1171:2002 PN16

www.ecivalve.it

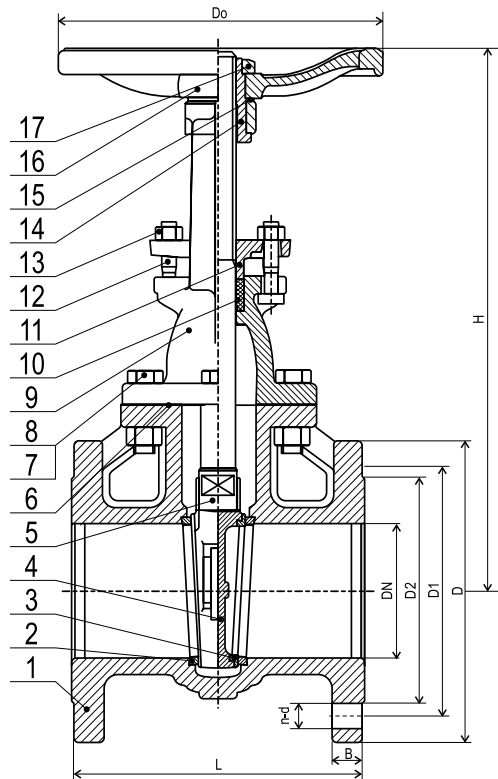

Specifications:

- OUTSIDE SCREW & YOKE
- PRESSURE-TEMPERATURE RATING: 16 BAR AT -10 TO 120°C 12.8 BAR AT 200°C
- TEST PRESSURES HYDRAULIC: SHELL: 24 BAR, SEAT: 17.6 BAR
- DESIGN AND MANUFACTURE CONFORM TO BS5150 (BS EN 1171:2002 PN 16)
- FACE TO FACE DIMENSIONS CONFORM TO SERIES 3 OF BS EN 558-1
- FLANGE DRILLED CONFORM TO BS EN 1092-2 PN 16
- GATE VALVES ARE DESIGNED TO BE IN AN OPEN OR CLOSED POSITION
- SUITABLE MEDIA: WATER & OIL

Dimensions (mm)

| DN | L | D | D1 | D2 | n-d | B | f | Do | H CLOSED | WEIGHT KGS |
|-----|-----|-----|-----|-----|-------|----|---|-----|-------------|---------------|
| 50 | 178 | 165 | 125 | 102 | 4-19 | 20 | 3 | 180 | 240 | 14.1 |
| 65 | 190 | 185 | 145 | 122 | 4-19 | 20 | 3 | 180 | 265 | 18.2 |
| 80 | 203 | 200 | 160 | 138 | 8-19 | 22 | 3 | 200 | 323 | 23.8 |
| 100 | 229 | 220 | 180 | 158 | 8-19 | 24 | 3 | 254 | 365 | 36.1 |
| 125 | 254 | 250 | 210 | 188 | 8-19 | 26 | 3 | 254 | 413 | 48.9 |
| 150 | 267 | 285 | 240 | 212 | 8-23 | 26 | 3 | 300 | 477 | 66.3 |
| 200 | 292 | 340 | 295 | 288 | 12-23 | 30 | 3 | 300 | 585 | 102 |
| 250 | 330 | 405 | 355 | 320 | 12-28 | 32 | 3 | 350 | 710 | 184 |
| 300 | 356 | 460 | 410 | 378 | 12-28 | 32 | 4 | 400 | 789 | 254 |

Materials

| No. | DESCRIPTION | MATERIAL | BRITISH STANDARD |
|-----|------------------|--------------|--------------------|
| 1 | Body | Cast Iron | 1561 EN JL 1030 |
| 2 | Seat Ring | Bronze | 1982 CC 491K |
| 3 | Wedge Seat Ring | Bronze | 1982 CC 491K |
| 4 | Wedge | Cast Iron | 1561 EN JL 1030 |
| 5 | Stem | Brass | 12164 CW603R |
| 6 | Gasket | Graphite | Non Asbestos |
| 7 | Bolt | Steel | Steel |
| 8 | Nut | Steel | Steel |
| 9 | Bonnet | Cast Iron | 1561 EN JL 1030 |
| 10 | Packing | Graphite | Non Asbestos |
| 11 | Gland Follower | Ductile Iron | ASTM A536 60-40-18 |
| 12 | Bolt | Steel | Steel |
| 13 | Nut | Steel | Steel |
| 14 | Stem Nut | Brass | Mn Brass |
| 15 | Handwheel Washer | Brass | Mn Brass |
| 16 | Handwheel | Cast Iron | EN JL 1030 |
| 17 | Handwheel Nut | Steel | Steel |



All data, descriptions and pictures contained in this leaflet may be subject to change without prior notice.

European Casting Industry Srl | Via Lazzaretto, 11 | 20124 Milan MI, Italia | P.Iva: 03228761205 | www.ecivalve.it | info@ecivalve.it

G 511

DUCTILE IRON RESILIENT SEATED GATE VALVE PN16

FLANGED END ACCORDING TO EN 1092-2 (DIN3254)

NON RISING STEM

DESIGNED AND MANUFACTURED ACCORDING

TO EN1171 (DIN3352)

DM174/2004 CERTIFIED FOR POTABLE WATER



www.ecivalve.it

ECI EUROPEAN CASTING INDUSTRY

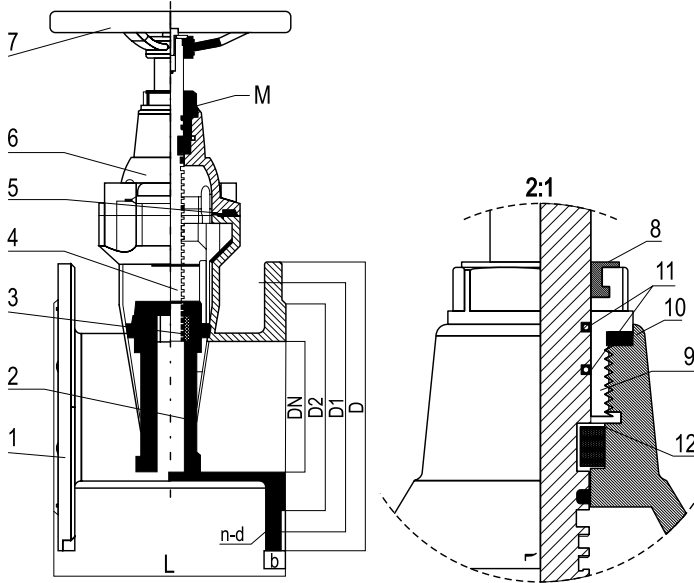

Specifications:

- DESIGNED AND MANUFACTURED ACCORDING TO EN1171 (DIN3352)
- BODY MATERIAL CONFORMS TO EN-GJS-500-10 (GGG50)
- FACE TO FACE ACCORDING TO EN558-1 SERIES 14 (EX DN3202 F4)
- FLANGED END ACCORDING TO EN 1092-2 (DIN3252)
- EPOXY COATED PAINT BLUE RAL5005 (MIN. 250 MM)
- WORKING PRESSURE: 16 BAR
- DM174/2004 CERTIFIED
- HYDRAULIC TEST PRESSURE: 17 BAR
- HYDRAULIC TEST ACCORDING TO BS EN 12266-1
- WORKING TEMPERATURE: -5°C + 80°C
- WORKING MEDIUM: WATER AND NON DANGEROUS LIQUIDS BELOW 0°C ONLY FOR WATER WITH ANTIFREEZE FLUIDS
- TESTED AND CONFORMS TO EN 1074-1/2

Dimensions (mm)

| DN | INCH | L | D | D1 | D2 | b | n-d | WEIGHT KGS |
|-----|--------|-----|-----|-----|-----|------|-------|------------|
| 50 | 2" | 150 | 165 | 125 | 102 | 19 | 4-19 | 9.50 |
| 65 | 2.1/2" | 170 | 185 | 145 | 122 | 19 | 4-19 | 12.50 |
| 80 | 3" | 180 | 200 | 160 | 132 | 19 | 8-19 | 15.50 |
| 100 | 4" | 190 | 220 | 180 | 156 | 19 | 8-19 | 17.80 |
| 125 | 5" | 200 | 250 | 210 | 184 | 19 | 8-19 | 31 |
| 150 | 6" | 210 | 285 | 240 | 211 | 19 | 8-23 | 33 |
| 200 | 8" | 230 | 340 | 295 | 266 | 20 | 12-23 | 49 |
| 250 | 10" | 250 | 405 | 355 | 319 | 22 | 12-28 | 82 |
| 300 | 12" | 270 | 460 | 410 | 370 | 24,5 | 12-28 | 112 |
| 350 | 14" | 290 | 520 | 470 | 429 | 26,5 | 16-28 | 190 |
| 400 | 16" | 310 | 580 | 525 | 480 | 28 | 16-30 | 251 |
| 450 | 18" | 330 | 640 | 585 | 550 | 28 | 20-30 | 320 |
| 500 | 20" | 350 | 715 | 650 | 610 | 30 | 20-33 | 394 |
| 600 | 24" | 390 | 840 | 770 | 725 | 32 | 20-36 | 580 |

Materials

| No. | DESCRIPTION | MATERIAL | STANDARD |
|-----|------------------|-----------------|------------------|
| 1 | Body | Ductile Iron | EN-GJS-500-10 |
| 2 | Wedge | DI+EPDM | EN-GJS-500-10 |
| 3 | Stem nut | Brass | - |
| 4 | Stem | Stainless Steel | AISI SS420/SS316 |
| 5 | Bonnet Gasket | EPDM | EPDM |
| 6 | Bonnet | Ductile Iron | EN-GJS-500-10 |
| 7 | Handwheel | Ductile Iron | EN-GJS-500-10 |
| 8 | Anti Dust Ring | EPDM | EPDM |
| 9 | Locking Nut | Brass | - |
| 10 | Sealing Ring | EPDM | EPDM |
| 11 | O Ring | EPDM | - |
| 12 | Positioning Ring | Brass | - |



All data, descriptions and pictures contained in this leaflet may be subject to change without prior notice.

European Casting Industry Srl | Via Lazzaretto, 11 | 20124 Milan MI, Italia | P.Iva: 03228761205 | www.ecivalve.it | info@ecivalve.it

G 801

DUCTILE IRON BALANCING VALVE VARIABLE ORIFICE DOUBLE REGULATING VALVE (VODRV)

FLANGED TO CLASS 125 OR PN16
Conforms to BS 7350 PN16

www.ecivalve.it

ECI EUROPEAN
CASTING
INDUSTRY

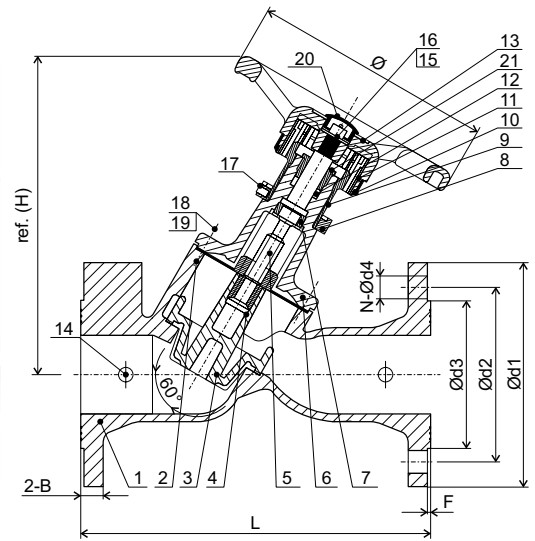

Pressure / Temperature Ratings

| TEMPERATURE (°C) | PRESSURE (BAR) |
|------------------|----------------|
| -10 to 120 | 16.0 |

Ratings align with BS EN 1092-2 PN16
(formerly BS 4504) or CL 125

Materials

| | PART NAME | MATERIAL | BRITISH STANDARD |
|----|---------------------------|-----------------|--|
| 1 | Body | Ductile Iron | EN-JS 1040/65-45-12 |
| 2 | Seal Gasket | EPDM | EPDM |
| 3 | Disc | Brass | EN12165 CW617N |
| 4 | Stem Nut | Brass | EN12165 CW617N |
| 5 | Stem | Stainless Steel | From DN65-DN300 BS970 410S21 |
| | | | From DN350-DN500 BS970 431S29 DN600 SS630 |
| 6 | Cover | Ductile Iron | EN-JS 1040 |
| 7 | Stem Locking Bush | Brass | EN12165 CW617N |
| 8 | Limit Set of Indicator | Brass | From DN65-DN300 EN12165 CW617N+Galvanization |
| | | Stainless Steel | From DN350-DN600 BS970 304S15 |
| 9 | Oriented Set of Indicator | Brass | EN12165 CW617N |
| 10 | Directed Circle | ABS | ABS |
| 11 | Indicator | ABS | ABS |
| 12 | Packing | PTFE+EPDM | PTFE+EPDM |
| 13 | Hand wheel | Ductile Iron | EN-JS 1040/65-45-12 |
| 14 | Plug | Steel | Steel |
| 15 | Bolt | Stainless Steel | BS970 304S15 |
| 16 | Big Gasket Hexagon | Stainless Steel | BS970 304S15 |
| 17 | Socket Screws | Stainless Steel | BS970 304S15 |
| 18 | Bolt | Stainless Steel | BS970 304S15 |
| 19 | Spring Gasket | Stainless Steel | BS970 304S15 |
| 20 | Indicator Dust Cover | ABS | ABS |
| 21 | Packing Gland | Brass | From DN65-DN150 EN12165 CW617N |
| | | Ductile Iron | From DN200-DN600 EN-JS 1040/65-45-12 |

Specifications:

- Y PATTERN GLOBE VALVE SUPPLIED WITH TWO TEST POINTS
- PROVIDE FLOW MEASUREMENT & REGULATION
- TO BE USED FOR ISOLATING & TO BE REOPENED TO IT'S PRESET POSITION
- ACCURACY ± 5% ON ALL SETTING
- DESIGN & MANUFACTURE CONFORM TO BS 7350 PN16
- SUITABLE MEDIUM: WATER
- WORKING TEMPERATURE: T ≤ 120° C

Coefficients

| DN | FLOW (Kv) | HEADLOSS (K) |
|-----|-----------|--------------|
| 65 | 104 | 5.32 |
| 80 | 116 | 6.48 |
| 100 | 213 | 13.15 |
| 125 | 333 | 8.32 |
| 150 | 476 | 7.33 |
| 200 | 768 | 8.26 |
| 250 | 1153 | 7.27 |
| 300 | 1743 | 8.36 |

*Fully open position.

Dimensions (mm)

| DN | H | L | B | Ø | Ød1 | Ød2 | Ød3 | N-Ød4 | F |
|-----|------|------|------|-----|-----|-----|-----|---------|---|
| 65 | 263 | 290 | 19 | 200 | 185 | 145 | 118 | 4-Ø 19 | 3 |
| 80 | 268 | 310 | 19 | 200 | 200 | 160 | 132 | 8-Ø 19 | 3 |
| 100 | 300 | 350 | 19 | 240 | 220 | 180 | 156 | 8-Ø 19 | 3 |
| 125 | 328 | 400 | 19 | 290 | 250 | 210 | 184 | 8-Ø 19 | 3 |
| 150 | 340 | 480 | 19 | 290 | 285 | 240 | 211 | 8-Ø 23 | 3 |
| 200 | 525 | 600 | 20 | 350 | 340 | 295 | 266 | 12-Ø 23 | 3 |
| 250 | 572 | 730 | 22 | 420 | 405 | 355 | 319 | 12-Ø 28 | 3 |
| 300 | 686 | 850 | 24.5 | 420 | 460 | 410 | 370 | 12-Ø 28 | 4 |
| 350 | 681 | 980 | 26.5 | 420 | 520 | 470 | 429 | 16-Ø 28 | 4 |
| 400 | 965 | 1100 | 28 | 640 | 580 | 525 | 480 | 16-Ø 31 | 4 |
| 450 | 972 | 1200 | 30 | 640 | 640 | 585 | 548 | 20-Ø 31 | 4 |
| 500 | 1065 | 1250 | 31.5 | 640 | 715 | 650 | 609 | 20-Ø 34 | 4 |
| 600 | 1180 | 1450 | 36 | 640 | 840 | 770 | 720 | 20-Ø 37 | 5 |

ECI EUROPEAN
CASTING
INDUSTRY

All data, descriptions and pictures contained in this leaflet may be subject to change without prior notice.

European Casting Industry Srl | Via Lazzaretto, 11 | 20124 Milan MI, Italia | P.Iva: 03228761205 | www.ecivalve.it | info@ecivalve.it





Pressure Independent Control Valves (PICV)

BS 925 (PICV)

46

BS 925 (PICV)

PRESSURE INDEPENDENT CONTROL VALVE

PN 25

www.ecivalve.it

ECI EUROPEAN
CASTING
INDUSTRY



The pressure independent control valve, combines an automatic control of the flow rate with a control of the valve through an actuator. The valve is able to regulate the flow rate and keep it constant as the differential pressure conditions vary within the hydraulic circuit in which it is installed. The valve can be used with two operating modes:

- independent control of the pressure (with actuator installed) in accordance with the thermal load requirements of the circuit section to be controlled;
- limitation of the flow rate and/or shut-off of the fluid (without actuator or with thermo-electric actuator installed).

Dimensions (mm)

| Code | DN Valve Body Size | Connections | Indicator Colour | Handwheel Colour | WORKING FLOW RATE RANGE [l/h] | | WORKING DIFFERENTIAL PRESSURE RANGE [kPa] | |
|------------|--------------------|-----------------------------|------------------|------------------|-------------------------------|--------------|---|------------------|
| | | | | | L (LOW) | H (HIGH) | WITH V1100/ V1200 ACTUATORS | WITHOUT ACTUATOR |
| BS925 0015 | 15 | G 1/2" M with tail pieces | BLUE | SKY-BLUE | 150÷380 l/h | 180÷630 l/h | 25÷400 kPa | 25÷800 kPa |
| BS9250020 | 20 | G 3/4" M with tail pieces | BLACK | SKY-BLUE | 320÷910 l/h | 700÷1175 l/h | 25÷400 kPa | 25÷800 kPa |
| BS9250025 | 20 | G 1" M with tail pieces | GREEN | SKY-BLUE | 290÷1000 l/h | 860÷1500 l/h | 25÷400 kPa | 25÷800 kPa |
| BS9250032 | 25 | G 1-1/4" M with tail pieces | BLACK | SKY-BLUE | 400÷4700 l/h | | U/A | 25÷400 kPa |

Accessories:

- V1100 - Thermo-electric Actuator normally closed 230V
- V1200 - Thermo-electric Actuator normally closed 24V

ECI EUROPEAN
CASTING
INDUSTRY

All data, descriptions and pictures contained in this leaflet may be subject to change without prior notice.

European Casting Industry Srl | Via Lazzaretto, 11 | 20124 Milan MI, Italia | P.Iva: 03228761205 | www.ecivalve.it | info@ecivalve.it

BS 925 (PICV)

PRESSURE INDEPENDENT CONTROL VALVE

PN 25

www.ecivalve.it

ECI EUROPEAN
CASTING
INDUSTRY

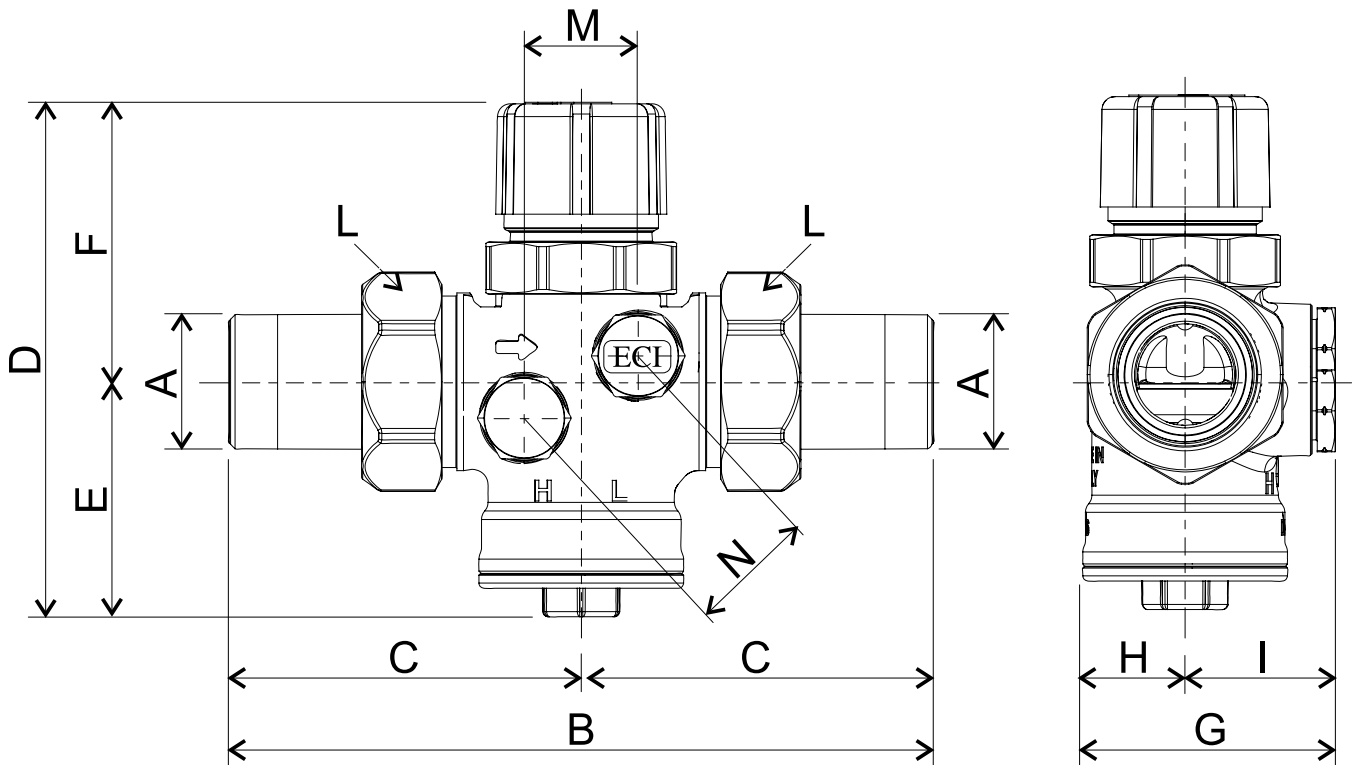

Dimensions (mm)

| DN Valve Body Size | A Connections | B | C | D | E | F | G | H | I | L | M | Weight(KGS) |
|-----------------------|------------------|-----|----|-----|----|----|----|----|----|-------|----|-------------|
| 15 | G 1/2" M | 128 | 64 | 99 | 45 | 54 | 49 | 20 | 29 | ch.30 | 22 | 0.625 |
| 20 | G 3/4" M | 136 | 68 | 99 | 45 | 54 | 49 | 20 | 29 | ch.38 | 22 | 0.78 |
| 20 | G 1" M | 142 | 71 | 99 | 45 | 54 | 49 | 20 | 29 | ch.38 | 22 | 0.825 |
| 25 | G 1.1/4" M | 165 | 83 | 111 | 52 | 59 | 65 | 30 | 35 | ch.53 | 27 | 1.56 |

Technical data:

- Fluids: water, glycol solutions (max. 50 % glycol)
- Temperature range: 5÷120 °C
- Room temperature range: 1÷50 °C
- Max. working pressure: 25 bar (2,5 MPa)
- Working differential pressure range: see table at pag.1
- Working flow rate range: see table at pag.1
- Regulation precision: ± 10 % regulated value
- Leakage rate (according to ISO 5208): class A, no leakage
- Connections for pressure outlets: G 1/4" F
- Actuator connection: M30 x 1,5 mm

ECI EUROPEAN
CASTING
INDUSTRY

All data, descriptions and pictures contained in this leaflet may be subject to change without prior notice.

European Casting Industry Srl | Via Lazzaretto, 11 | 20124 Milan MI, Italia | P.Iva: 03228761205 | www.ecivalve.it | info@ecivalve.it

BS 925 (PICV)

PRESSURE INDEPENDENT CONTROL VALVE

PN 25

www.ecivalve.it

ECI EUROPEAN
CASTING
INDUSTRY

Materials:

| DESCRIPTION | MATERIAL |
|-------------------------|-----------------------------|
| Body | Brass CW602n - UNI EN 12165 |
| Bonnet | Brass CW602n - UNI EN 12165 |
| Tail Pieces | Brass CW617N - UNI EN 12165 |
| Regulator Stem & Piston | Stainless Steel AISI 302 |
| Spring | Stainless Steel AISI 302 |
| Membrane | EPDM |
| Stopper | EPDM |
| O-Ring | EPDM |
| Bonnet Seperator | PA66-GF30 |

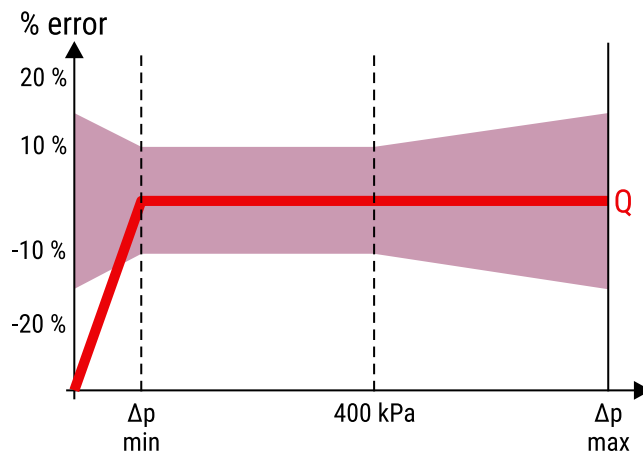

Operation

Through the manual handwheel it is possible to isolate the circuit section controlled by the valve. Turn the knob clockwise to close the handwheel;

counterclockwise to open it.

- with handwheel closed the complete flow shut-off is obtained;
- with handwheel open the flow rate limitation function is obtained at the preset value (see paragraph "Flow rate presetting").

The same function can also be obtained automatically by installing a thermoelectric actuator of the ON/OFF type, suitably electrically connected:

- with thermo-electric actuator closed the complete flow shut-off is obtained;
- with thermo-electric actuator open the flow rate stabilization function is obtained at the preset value (see paragraph "Flow rate presetting").

BS 925 (PICV)

PRESSURE INDEPENDENT CONTROL VALVE

PN 25

www.ecivalve.it

ECI EUROPEAN
CASTING
INDUSTRY

Flow-rate presetting

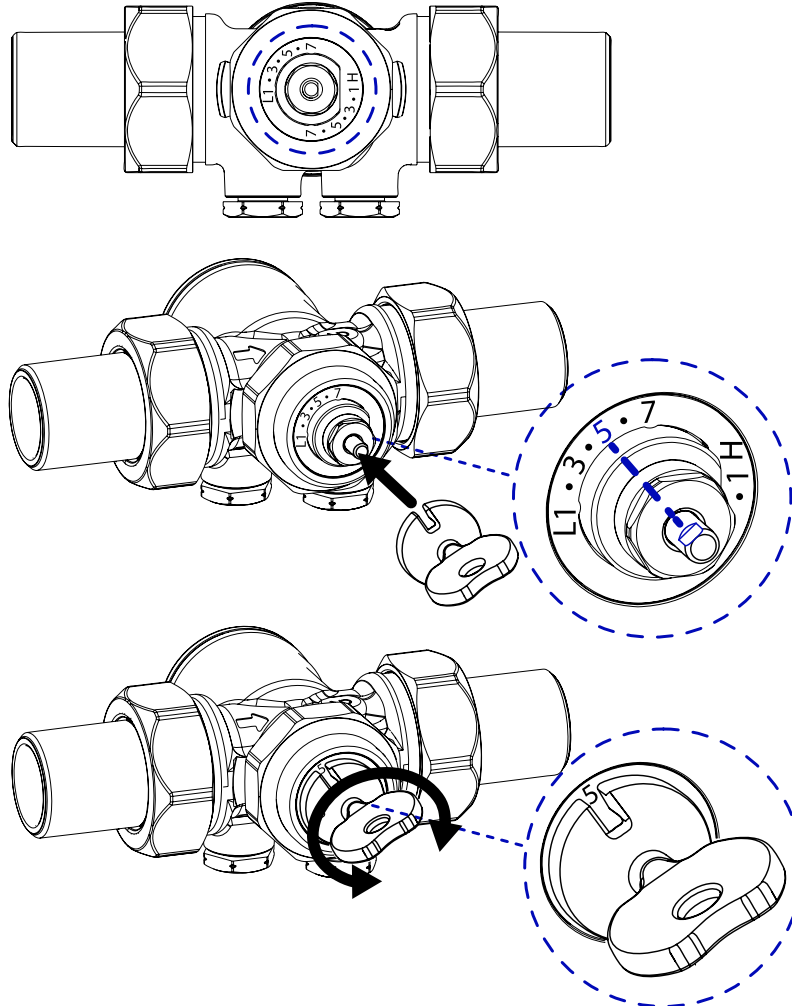

The BS9250015/20/25 valves are equipped with a double regulation scale of the flow rate:

- **L (LOW)**: for low flow rate
- **H (HIGH)**: for high flow rate

To set the valve adjustment based on the desired flow rate, use the **regulation key included in the package** and turn the valve stem clockwise or counterclockwise until reaching the desired value printed on the plastic disk of the valve and identifiable through the table below. The transition from one regulation scale to the other is possible at any time, even during the operation of the system; in this way it is possible to choose the desired flow rate value without having to replace the valve.

The BS9250032 valves, instead, are equipped with a single regulation scale of the flow rate.

Example:

Design flow rate: 300 l/h
Piping DN15



Valve required: BS9250015
Regulation scale: L (LOW)
Position: 5

ECI EUROPEAN
CASTING
INDUSTRY

All data, descriptions and pictures contained in this leaflet may be subject to change without prior notice.

European Casting Industry Srl | Via Lazzaretto, 11 | 20124 Milan MI, Italia | P.Iva: 03228761205 | www.ecivalve.it | info@ecivalve.it

BS 925 (PICV)

PRESSURE INDEPENDENT CONTROL VALVE

PN 25

www.ecivalve.it



Flow-rate presetting

| Product Code | DN | Connections | WORKING DIFFERENTIAL PRESSURE RANGE [kPa] | | WORKING FLOW RATE RANGE [l/h] | | | | | | | | | | |
|--------------|----|-------------|---|------------------|-------------------------------|-----|-----|-----|------|------|------|------|------|------|------|
| | | | WITH V1100/V1200 Actuators | Without Actuator | Regulation | MIN | 1 | 2 | 3 | 4 | 5 | 6 | 7 | 8 | 9 |
| BS925 0015 | 15 | G 1/2"M | 25÷400 kPa | 25÷800 kPa | L (LOW) | - | 150 | 175 | 200 | 250 | 300 | 340 | 380 | - | - |
| | | | | | H (HIGH) | - | 180 | 250 | 350 | 440 | 500 | 570 | 630 | - | - |
| BS9250020 | 20 | G 3/4"M | 25÷400 kPa | 25÷800 kPa | L (LOW) | - | 320 | 400 | 520 | 640 | 770 | 870 | 910 | - | - |
| | | | | | H (HIGH) | - | 700 | 820 | 910 | 970 | 1030 | 1100 | 1175 | - | - |
| BS9250025 | 20 | G 1"M | 25÷400 kPa | 25÷800 kPa | L (LOW) | - | 290 | 400 | 500 | 640 | 730 | 900 | 1000 | - | - |
| | | | | | H (HIGH) | - | 860 | 900 | 940 | 1110 | 1270 | 1330 | 1500 | - | - |
| BS9250032 | 25 | G 1-1/4"M | U/ | 25÷400 kPa | A | - | 400 | 670 | 1200 | 1800 | 2300 | 3000 | 3600 | 4300 | 4700 |

Installation

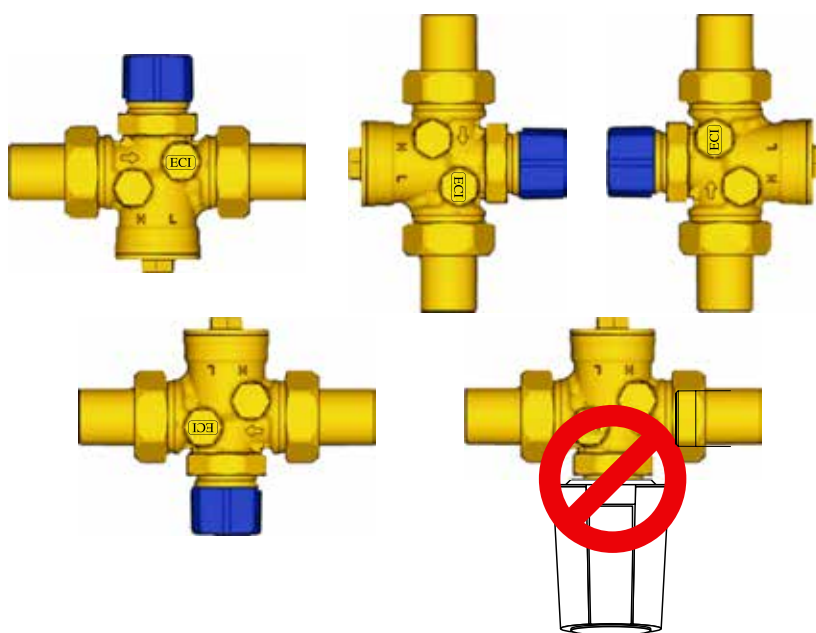
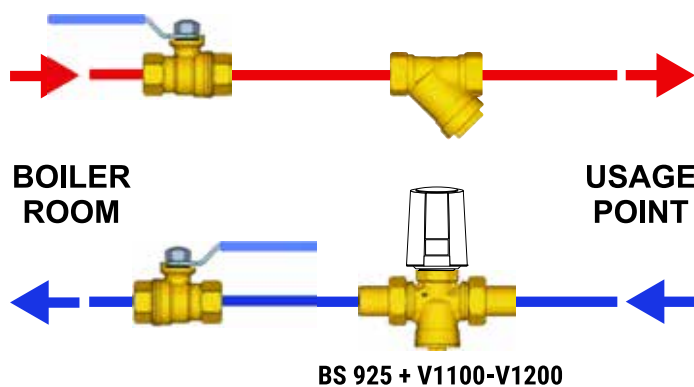

All data, descriptions and pictures contained in this leaflet may be subject to change without prior notice.

European Casting Industry Srl | Via Lazzaretto, 11 | 20124 Milan MI, Italia | P.Iva: 03228761205 | www.ecivalve.it | info@ecivalve.it

BS 925 (PICV)

PRESSURE INDEPENDENT CONTROL VALVE

PN 25

www.ecivalve.it

ECI EUROPEAN
CASTING
INDUSTRY

Installation of the pressure outlets and flow rate verification through the differential pressure gauge

The valve is equipped with connections for the pressure outlets to be installed with the system switched off and not under pressure.

Using the differential pressure gauge and its probes suitably housed in the pressure outlets, it is possible to measure the Δp of the valve (P1-P3) during normal operation.

⚠ WARNINGS:

Water leakage may occur through the pressure outlets during the insertion of the probes.
Wear protective clothing and goggles to prevent personal injury during pressure measurement.
Do not use lubricants on the probes to facilitate insertion into the outlets. If necessary, wet the probes with clean water.
Do not leave the probes in the pressure outlet longer than necessary, as this could cause leakage.

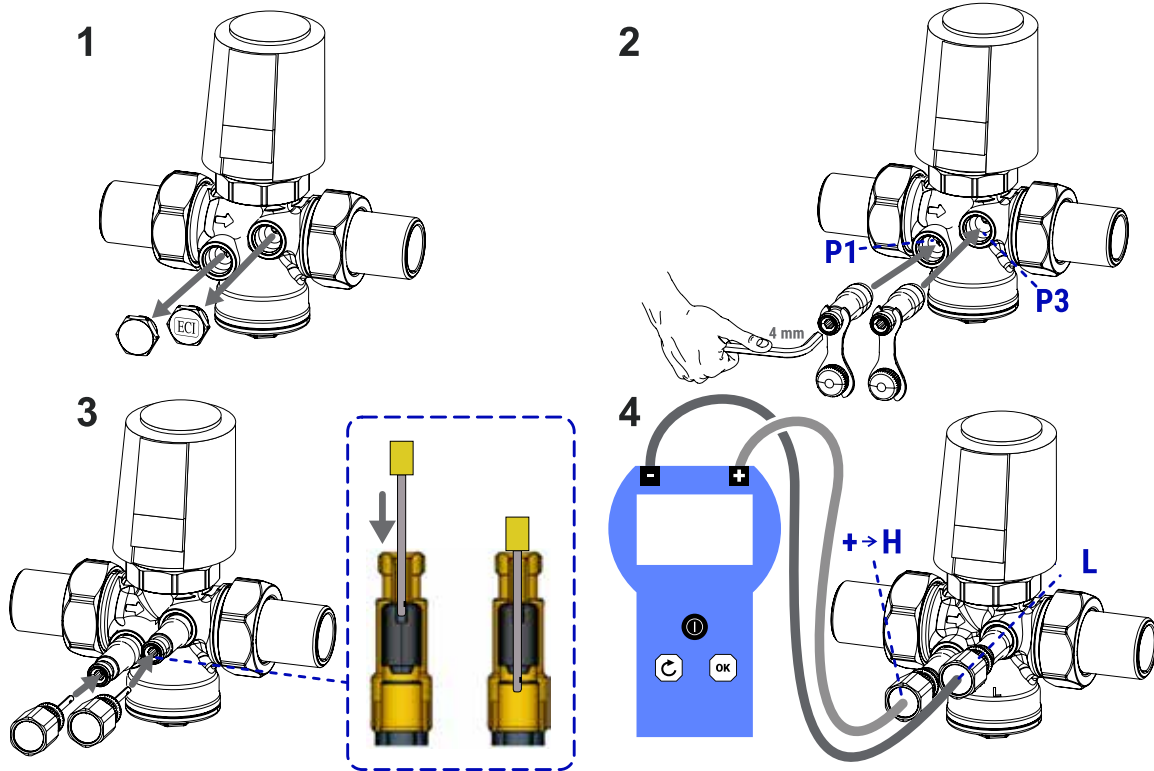

⚠ Safety Warning. Installation, commissioning and periodical maintenance of the product must be carried out by qualified operators in compliance with national regulations and/or local standards. A qualified installer must take all required measures, including use of Individual Protection Devices, for his and others' safety. An improper installation may damage people, animals or objects towards which ECI may not be held liable.

♻ Package Disposal. Carton boxes: paper recycling. Plastic bags and bubble wrap: plastic recycling.

♻ Product Disposal. Do not dispose of product as municipal waste at the end of its life cycle. Dispose of product at a special recycling platform managed by local authorities or at retailers providing this type of service.

ⓘ Additional information. For more information, go to the website www.ecivalve.it or contact us via email info@ecivalve.it. This document provides only general indications. The information included in this technical sheet do not exempt the user from strictly complying with the rules and good practice standards in force.

ECI EUROPEAN
CASTING
INDUSTRY

All data, descriptions and pictures contained in this leaflet may be subject to change without prior notice.

European Casting Industry Srl | Via Lazzaretto, 11 | 20124 Milan MI, Italia | P.Iva: 03228761205 | www.ecivalve.it | info@ecivalve.it





Valve Accessories

V1100/V1200

54

V1100/V1200

Thermo Electric actuator normally Closed ON/OFF
230V/24V for Pressure Independent Control Valve BS925

www.ecivalve.it

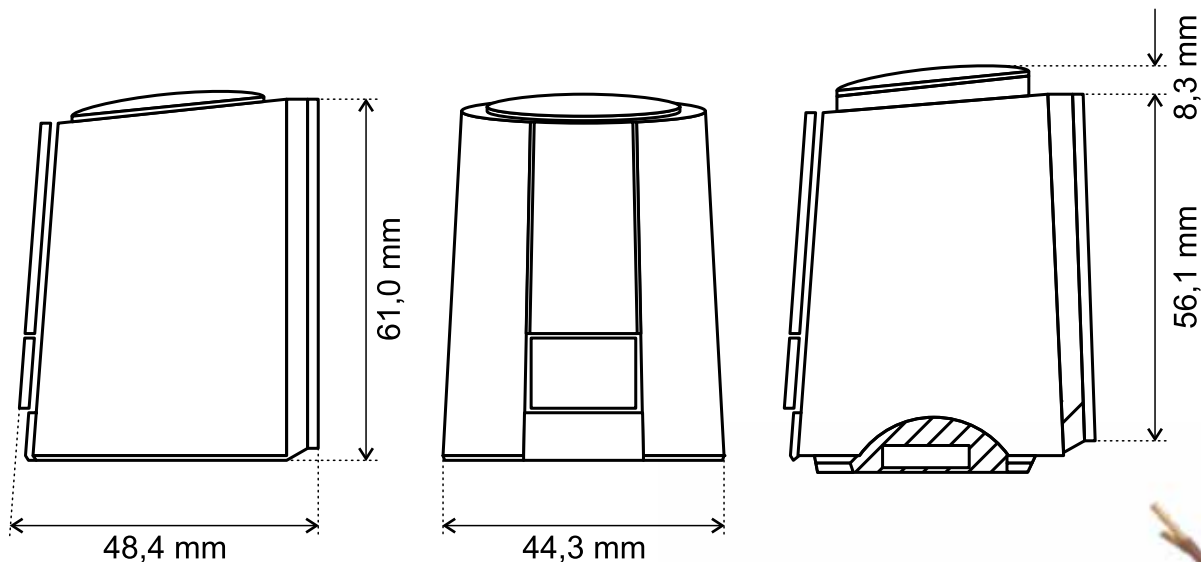

Dimensions (mm)

| A | B | C | D | E | Weight(KGS) |
|------|----|------|------|-----|-------------|
| 48.4 | 61 | 44.3 | 59.1 | 8.3 | 0.108 |

Specifications:

V1100

- Supply Voltage: 230V AC \pm 10%, 50/60Hz
- Type: Thermal
- Power consumption: 1W
- Control Signal: ON/OFF
- Failsafe Function: Yes, normally closed
- End switch: No
- Operation time: Aprox 4 minutes
- Actuation force: 100N \pm 5%
- Room Temperature: 0°C to 60 °C
- Fluid Temperature: 0°C to 100°C
- Storage Temperature: -25°C to 60°C
- Cable: Fixed, 2 wires x 0.75mm² PVC, 1m standard M30x1.5mm connection
- Conforms to EN 60730 standard

V1200

- Supply Voltage: 24V AC/DC -10% +20% , 50/60Hz
- Type: Thermal
- Power consumption: 1W
- Control Signal: ON/OFF
- Failsafe Function: Yes, normally closed
- End switch: No
- Operation time: Aprox 4 minutes
- Actuation force: 100N \pm 5%
- Room Temperature: 0°C to 60 °C
- Fluid Temperature: 0°C to 100°C
- Storage Temperature: -25°C to 60°C
- Cable: Fixed, 2 wires x 0,75mm² PVC, 1m standard M30x1.5mm connection
- Conforms to EN 60730 standard



All data, descriptions and pictures contained in this leaflet may be subject to change without prior notice.

European Casting Industry Srl | Via Lazzaretto, 11 | 20124 Milan MI, Italia | P.Iva: 03228761205 | www.ecivalve.it | info@ecivalve.it

Certifications



All data, descriptions and pictures contained in this leaflet may be subject to change without prior notice.

European Casting Industry Srl | Via Lazzaretto, 11 | 20124 Milan MI, Italia | P.Iva: 03228761205 | www.ecivalve.it | info@ecivalve.it



Via Lazzaretto, 11
20124 Milan MI, Italy
Tel & Fax #: +39 0263793708
www.ecivalve.it

