

BR 516

BRONZE GATE VALVE

PN16

Non-Rising stem

Conforms to PED 97/23/CE & it is CE marking-free as per art. 3 par.3

www.ecivalve.it

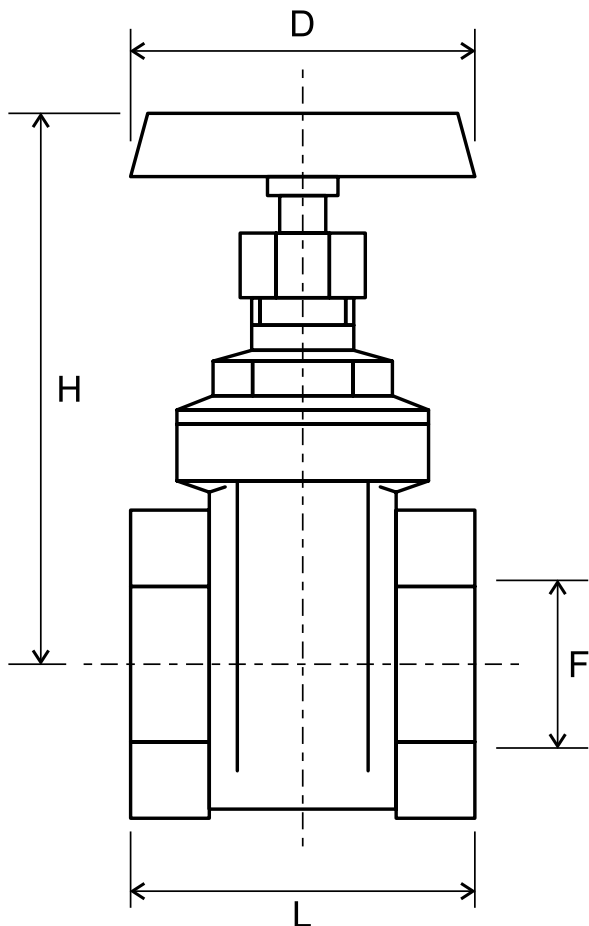

Specifications:

- PRESSURE RATING: PN16
- SUITABLE MEDIA: WATER, OIL & AIR
- WORKING TEMPERATURE: $T \leq 80^{\circ}\text{C}$
- TAPER PIPE THREAD TO NPT AND ISO 228/1

Dimensions (mm)

DN	SIZE INCH	F	L	H	D	Weight(KGS)
15	½"	15	38	68	45	0.195
20	¾"	19	45	78	50	0.280
25	1"	24	48	92	55	0.380
32	1¼"	32	51	108	60	0.600
40	1½"	37	58	125	70	0.830
50	2"	47	62	145	80	1.210

Materials

DESCRIPTION	MATERIAL
Body	Bronze SN 5 UNI-EN1982 DIN50930/6
Bonnet	Brass CW 617 N-UNI-EN12165
Stem	Brass CW 614 N-UNI-EN12164
Packing	EPDM90 DUTRAL
Wedge	Brass DELTA CS UNI-EN1982 CB 7535
Handwheel	Steel with blue plastic coating
Handwheel Nut	Steel Zinc plated



All data, descriptions and pictures contained in this leaflet may be subject to change without prior notice.

European Casting Industry Srl | Via Lazzaretto, 11 | 20124 Milan MI, Italia | P.Iva: 03228761205 | www.ecivalve.it | info@ecivalve.it